

# Zangenspannfutter

## Collet Holders



Seite 98  
page 98



Spannzangenreduktion  
Collet Reduction

Seite 101  
page 101



ER-Doppelhalter  
ER-Double Holders

Seite 106  
page 106



Zangenspannfutter Divers  
Collet Holders Divers

Seite 110  
page 110



INOGRIP  
INOGRIP Hydrosystem

- Alle Zangenspannfutter werden inkl. Standardmutter geliefert
- Zangenspannfutter mit "AK" werden inkl. abgedichteter Mutter geliefert.
- Rundlaufgenauigkeit der ER Zangenspannfutter < 5 µm
- Abkürzungen bei den Halter-Bezeichnungen:

- All holders will be supplied with clamping nut (standard)
- Holders with "AK" will be supplied with sealed nut
- Runout accuracy ER-collet holders < 5µm
- List of abbreviations:

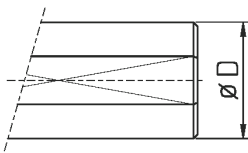
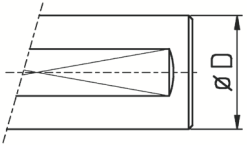
IK	axialer Kühlmittelanschluss		axial inner coolant inlet
AK	seitlicher (radialer) Kühlmittelanschluss		radial inner coolant inlet
WD	durchgehende Spannfläche		throughout flat
FL	abgesetzte Spannfläche		no throughout flat
T	speziell für Tornos Maschinen		especially for TORNOS machines
OS	ohne Anschlagsschraube		without inner stop screw

Gewinde des Kühlmittelanschlusses: Thread inner coolant lead in:	
AK0	M12 x 1,5
AK1	G 1/8"
AK2	M8 x 1
AK3	M10 x 1

- B = kleinster Durchmesser  
*B = smallest diameter*
- Umfangreiches Spannzangen-Sortiment im Teil 1. "Werkstück- und Werkzeug-spannung"  
*Large assortment of collets see in part 1. "Workpiece and Tool Clamping"*



- Überstandsmaße von Muttern bei Zangenspannfutter

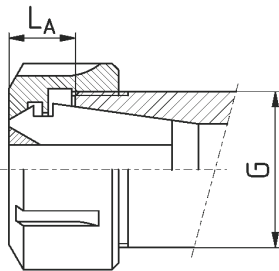
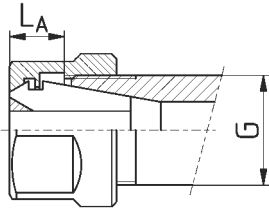

- Collet holders: Overlap of nuts

Mutter nut	G	LA
ER08M	M10x0,75	4,3 - 6,1
ER11M	M13x0,75	5,7 - 7,5
ER16M	M19x1	8 - 11,5
ER20M	M24x1	8 - 11,5
ER25M	M30x1	8,5 - 12
UM/ER11	M14x0,75	4,9 - 6,6
UM/ER16	M22x1,5	7 - 10,5
UM/ER20	M25x1,5	8 - 11,5
UX/ER16	M22x1,5	7 - 10,5
UX/ER20	M25x1,5	8 - 11,5
UM/ER25	M32x1,5	8,5 - 12
UM/ER32	M40x1,5	9,5 - 13
UM/ER40	M50x1,5	11,5 - 15
UM/ER50	M64x2,0	14 - 21

- Alle Halter AK0 können auf AK1 - AK3 reduziert werden
- IK-Reduzierungen:

- All holders AK0 can be reduced to AK1 - AK3
- inner coolant (IK):

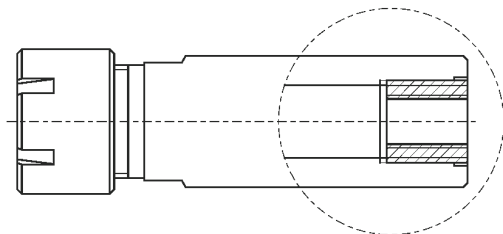

### Anwendungsbeispiel - example

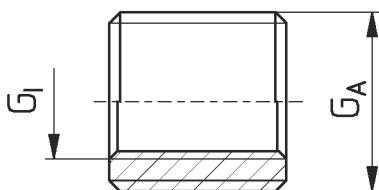

Artikel-Nr. article-no.	GA	GI
RED1/4 - 1/8	G1/4"	G1/8"
RED1/4 - M10x1	G1/4"	M10 x 1
RED1/4 - M8x1	G1/4"	M8 x 1
RED1/8 - M8x1	G1/8"	M8 x 1
REDM12x1,5 - G1/8	M12 x 1,5	G1/8"
REDM12x1,5 - M10x1	M12 x 1,5	M10 x 1
REDM12x1,5 - M8x1	M12 x 1,5	M8 x 1
RED1/8 - 1/8NPT	G1/8"	1/8"NPT
REDM8x1 - 1/8NPT	M8 x 1	1/8"NPT

## ER-Zangenspannfutter ER08M

## ER-Collet Holders ER08M

Ausführungen:

Versions:

Vgl. auch S. 69 - 70

See also page 69 - 70



Bild 1 (WD)



Bild 2 (FL)

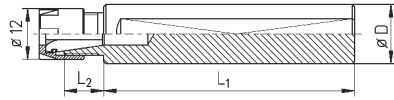

Bild 3 (B)

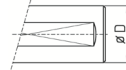

Bild 4 (IK)

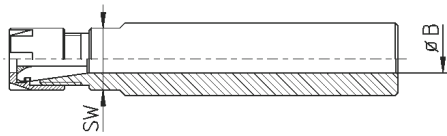

ER08M = M10 x 0,75

Abbildungen können abweichen - catalog drawings may differ

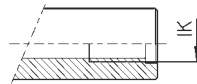
Artikel-Nr. article-no.	Zange collet	D	L <sub>1</sub>	L <sub>2</sub>	IK / B ic / B	SW	Bild picture	Mutter nut	Schlüssel spanner
EM080570	ER08	5	68	15,5	-	8	1 *	ER08M	E08M
EM080635	ER08	6	35	24	-	12	1 *	ER08M	E08M
EM080670	ER08	6	70	17	-	8	1 *	ER08M	E08M
EM080820B-Sonder	ER08	8	18	13	3	-	3 *	ER08M	E08M
EM080855	ER08	8	55	17,5	-	9	1 *	ER08M	E08M
EM080870	ER08	8	70	16	-	8	1 *	ER08M	E08M
EM0808120	ER08	8	118	16	-	8	1 *	ER08M	E08M
EM0808125	ER08	8	125	16	-	8	1 *	ER08M	E08M
EM0808125WD	ER08	8	125	16	-	8	1	ER08M	E08M
EM081015	ER08	10	15	12	-	9,5	1 *	ER08M	E08M
EM081082FL	ER08	10	82	8	-	8	1 / 2	ER08M	E08M
EM081084	ER08	10	84	8	5	8	1 *	ER08M	E08M
EM0810120	ER08	10	118	8	-	8	1 *	ER08M	E08M
EM0810120FL	ER08	10	118	8	-	8	1 / 2	ER08M	E08M
EM081245	ER08	12	45	9,5	-	10	1 *	ER08M	E08M
EM081245FL	ER08	12	45	9,5	-	10	1 / 2	ER08M	E08M
EM081280	ER08	12	80	8	-	10	1 *	ER08M	E08M
EM081280FL	ER08	12	80	8	-	10	1 / 2	ER08M	E08M
EM0812125	ER08	12	125	9,5	-	10	1 *	ER08M	E08M
EM0812125FL	ER08	12	125	9,5	-	10	1 / 2	ER08M	E08M
EM0812138	ER08	12	138	11	6	12	3 *	ER08M	E08M
EM0812140	ER08	12	140	10	-	10	1 *	ER08M	E08M
EM0812150	ER08	12	150	9,5	6	10	3 *	ER08M	E08M
EM0812200	ER08	12	200	9	-	10	1 *	ER08M	E08M
EM081460WD	ER08	14	60	10	7	12	3	ER08M	E08M
EM081460IKWD	ER08	14	60	10	M8x1	12	4	ER08M	E08M
EM085830WD	ER08	5/8"	30	9	7	14	3	ER08M	E08M
EM085845WD	ER08	5/8"	45	11	5	14	3	ER08M	E08M
EM081645	ER08	16	45	9,5	7	14	3 *	ER08M	E08M
EM081645WD	ER08	16	45	9,5	7	14	3	ER08M	E08M

\* = ohne Spannfläche - without flat

## ER-Zangenspannfutter ER11M

## ER-Collet Holders ER11M

Ausführungen:

Versions:

Vgl. auch S. 69 - 70

See also page 69 - 70



Bild 1 (WD)

Bild 2 (FL)



ER11M = M13 x 0,75

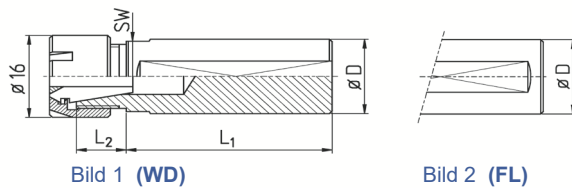

Bild 3 (B)



Bild 4 (IK)

Abbildungen können abweichen - catalog drawings may differ

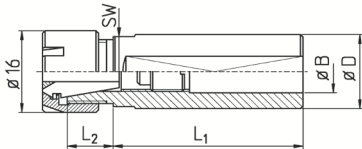
Artikel-Nr. article-no.	Zange collet	D	L <sub>1</sub>	L <sub>2</sub>	IK / B ic / B	SW	Bild picture	Mutter nut	Schlüssel spanner
* EM110554	ER11	5	54	23	-	11	1 *	ER11M	E11M
EM110655	ER11	6	55	20	-	11	1 *	ER11M	E11M
EM110756	ER11	7	56	20	-	11	1 *	ER11M	E11M
EM110856	ER11	8	56	20	-	11	1 *	ER11M	E11M
EM1108100	ER11	8	100	21	-	11	1 *	ER11M	E11M
* EM111060FL	ER11	10	60	21	-	11	1 / 2	ER11M	E11M
EM111060	ER11	10	60	20	-	11	1 *	ER11M	E11M
EM111080	ER11	10	80	20	-	11	1 *	ER11M	E11M
EM111080FL	ER11	10	80	20	-	11	1 / 2	ER11M	E11M
* EM1110120	ER11	10	120	20	-	11	1 *	ER11M	E11M
* EM1110125	ER11	10	125	21	-	11	1 *	ER11M	E11M
EM111240	ER11	12	40	20	7	11	3 *	ER11M	E11M
EM111240FL	ER11	12	40	18	-	11	1 / 2	ER11M	E11M
* EM111240WD	ER11	12	40	18	-	11	1	ER11M	E11M
EM111280	ER11	12	80	17	-	11	1 *	ER11M	E11M
EM111280FL	ER11	12	80	17	-	11	1 / 2	ER11M	E11M
EM1112124	ER11	12	124	20	-	11	1 *	ER11M	E11M
EM1112125FL	ER11	12	125	17	-	11	1 / 2	ER11M	E11M
EM1112150	ER11	12	150	18	-	11	1 *	ER11M	E11M
EM1112150FL	ER11	12	150	18	-	11	1 / 2	ER11M	E11M
EM111370	ER11	1/2"	70	18	-	11	1 *	ER11M	E11M
EM111420	ER11	14	20	12	7,5	12	3 *	ER11M	E11M
EM111420WD	ER11	14	20	12	7,5	12	3	ER11M	E11M
EM115850IK	ER11	5/8"	50	12	G1/8"	14	4 *	ER11M	E11M
EM115850IKWD	ER11	5/8"	50	12	G1/8"	14	4	ER11M	E11M
EM115880	ER11	5/8"	80	11	8	14	3 *	ER11M	E11M
EM1158125IKFL	ER11	5/8"	125	12	G1/8"	14	2 / 4	ER11M	E11M
EM111620	ER11	16	20	12	7	14	3 *	ER11M	E11M
EM111620FL	ER11	16	20	12	7	14	2 / 3	ER11M	E11M
EM111620WD	ER11	16	20	12	7	14	3	ER11M	E11M
EM111630	ER11	16	30	12	8,5	14	3 *	ER11M	E11M
EM111630WD	ER11	16	30	12	8,5	14	3	ER11M	E11M
EM111636IKWD	ER11	16	36	12	G1/8"	14	4	ER11M	E11M

\* = ohne Spannfläche - without flat

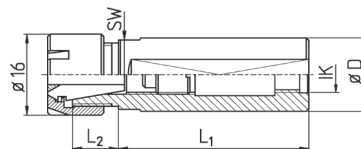
\* Ausverkaufsartikel - sellout article

Artikel-Nr. article-no.	Original-Nr. original-no.	Zange collet	D	L <sub>1</sub>	L <sub>2</sub>	IK / B ic / B	SW	Bild picture	Mutter nut	Schlüssel spanner
EM111655		ER11	16	55	12	8	14	3 *	ER11M	E11M
EM111655IKWD		ER11	16	55	12	G1/8"	14	4	ER11M	E11M
EM111675IKTWD		ER11	16	75	15	G1/8"	14	4	ER11M	E11M
EM111680		ER11	16	80	12	8	14	3 *	ER11M	E11M
EM111680IKFL	691-21	ER11	16	80	12	G1/8"	14	2 / 4	ER11M	E11M
* EM111698IKWD		ER11	16	98	15	G1/8"	14	4	ER11M	E11M
EM1116100		ER11	16	100	13	-	14	1 *	ER11M	E11M
EM1116125		ER11	16	125	12	6	14	3 *	ER11M	E11M
EM1116125FL		ER11	16	125	12	6	14	2 / 3	ER11M	E11M
EM1116140		ER11	16	140	12	-	14	1 *	ER11M	E11M
EM1116140FL		ER11	16	140	12	-	14	1 / 2	ER11M	E11M
EM1116150IKTWD		ER11	16	148	16	G1/8"	14	4	ER11M	E11M
EM1116150		ER11	16	150	12	6	14	3 *	ER11M	E11M
EM1116150M		ER11	16	150	12	-	14	1 *	ER11M	E11M
EM1116150MFL		ER11	16	150	12	-	14	1 / 2	ER11M	E11M
EM1116150FL		ER11	16	150	12	6	14	2 / 3	ER11M	E11M
EM1116160		ER11	16	160	15,5	8	14	3 *	ER11M	E11M
EM1116180		ER11	16	180	12	-	14	1 *	ER11M	E11M
EM1116220		ER11	16	220	13	-	14	1 *	ER11M	E11M
EM1116250		ER11	16	250	13	-	14	1 *	ER11M	E11M
EM1118115FL-Special		ER11	18	114	11	-	-	1 / 2	ER11M	E11M
EM1118310		ER11	18	310	12	-	15	1 *	ER11M	E11M
EM1118330		ER11	18	330	13	-	15	1 *	ER11M	E11M
EM111950IK		ER11	3/4"	50	13	G1/8"	17	4 *	ER11M	E11M
EM111950IKWD		ER11	3/4"	50	12	G1/8"	17	4	ER11M	E11M
EM111960WD		ER11	3/4"	60	12	8,5	17	3	ER11M	E11M
EM111970IK		ER11	3/4"	70	12	G1/8"	17	4 *	ER11M	E11M
EM111970IKFL		ER11	3/4"	70	12	G1/8"	17	2 / 4	ER11M	E11M
EM111970IKWD		ER11	3/4"	70	12	G1/8"	17	4	ER11M	E11M
EM1119100		ER11	3/4"	100	13	-	17	1 *	ER11M	E11M
* EM1119115FL-Special		ER11	3/4"	114	11	-	-	1 / 2	ER11M	E11M
EM112060IK		ER11	20	60	12	G1/8"	17	4 *	ER11M	E11M
EM112060IKWD		ER11	20	60	12	G1/4"	17	4	ER11M	E11M
EM112090IKWD		ER11	20	90	11	G1/8"	17	4	ER11M	E11M
EM1120100		ER11	20	100	12	-	17	1 *	ER11M	E11M
EM1120100IK		ER11	20	100	12	G1/4"	17	4 *	ER11M	E11M
EM1120100IKWD		ER11	20	100	12	G1/4"	17	4	ER11M	E11M
EM1120240		ER11	20	240	12	-	17	1 *	ER11M	E11M
EM1120240WD		ER11	20	240	12	-	17	1	ER11M	E11M
EM112270IKWD		ER11	22	70	12	G1/8"	19	4	ER11M	E11M
EM112290IKOSWD **		ER11	22	90	12	G1/4"	-	4	ER11M	E11M
EM112290IKOS **		ER11	22	90	12	G1/4"	-	4 *	ER11M	E11M
EM1122120IKOS		ER11	22	120	12,5	G1/8"	-	4 *	ER11M	E11M
EM1122120IKOSWD		ER11	22	120	12	G1/8"	-	4	ER11M	E11M
EM1122120WD		ER11	22	120	12	7	19	3	ER11M	E11M
* EM1132125		ER11	22	125	11	-	27	1 *	ER11M	E11M

\* = ohne Spannfläche - without flat

\*\* = ohne Schlüsselfläche - without spanner flat

\* Ausverkaufsartikel - sellout article

## ER-Zangenspannfutter ER16M

## ER-Collet Holders ER16M

Ausführungen:

Versions:

Vgl. auch S. 69 - 70

See also page 69 - 70



Bild 1 (WD)



Bild 2 (FL)

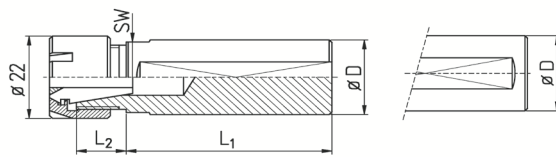

ER16M = M19 x 1

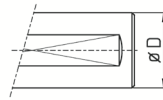

Bild 3 (B)



Bild 4 (IK)

Abbildungen können abweichen - catalog drawings may differ

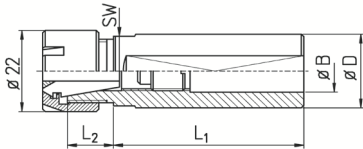
Artikel-Nr. article-no.	Zange collet	D	L <sub>1</sub>	L <sub>2</sub>	IK / B ic / B	SW	Bild picture	Mutter nut	Schlüssel spanner
EM160860	ER16	8	60	27	-	17	1 *	ER16M	E16M
EM161060	ER16	10	60	25	-	19	1 *	ER16M	E16M
EM161224	ER16	12	24	26	8	17	3 *	ER16M	E16M
EM161280	ER16	12	80	26	-	17	1 *	ER16M	E16M
EM1613100	ER16	1/2"	100	27	-	17	1 *	ER16M	E16M
EM161418IKFL	ER16	14	18	25	M8x1	17	2 / 4	ER16M	E16M
EM161418IK	ER16	14	18	22	M8x1	17	4 *	ER16M	E16M
* EM161530FL	ER16	15	30	25	9	17	2 / 3	ER16M	E16M
* EM161590	ER16	15	90	20	-	17	1 *	ER16M	E16M
EM165835	ER16	5/8"	35	25	9	17	3 *	ER16M	E16M
EM165835FL	ER16	5/8"	35	25	9	17	2 / 3	ER16M	E16M
EM1658125	ER16	5/8"	125	25	9	17	3 *	ER16M	E16M
EM161620FL	ER16	16	20	25	9	17	2 / 3	ER16M	E16M
EM161630	ER16	16	30	25	10	17	3 *	ER16M	E16M
EM161630FL	ER16	16	30	25	10	17	2 / 3	ER16M	E16M
EM161635	ER16	16	35	25	10	17	3 *	ER16M	E16M
EM161635FL	ER16	16	35	25	10	17	2 / 3	ER16M	E16M
EM161670IK	ER16	16	70	25	G1/8"	17	4 *	ER16M	E16M
EM161670FL	ER16	16	70	25	10	17	2 / 3	ER16M	E16M
EM161680IK	ER16	16	80	27	G1/8"	17	4 *	ER16M	E16M
EM161680FL	ER16	16	80	27	9	17	2 / 3	ER16M	E16M
EM1616100	ER16	16	100	25	8,5	17	3 *	ER16M	E16M
EM1616100FL	ER16	16	100	25	9	17	2 / 3	ER16M	E16M
EM1616150IK	ER16	16	150	25	G1/8"	17	4 *	ER16M	E16M
EM1616150FL	ER16	16	150	25	-	17	2 / 3	ER16M	E16M
EM1616160	ER16	16	160	27	8,5	17	3 *	ER16M	E16M
EM1616160FL	ER16	16	160	27	8,5	17	2 / 3	ER16M	E16M
EM1618110IKWD	ER16	18	110	25	G1/8"	17	3	ER16M	E16M
* EM1618280	ER16	18	280	25	-	15	1 *	ER16M	E16M
EM161940IK	ER16	3/4"	39	13	G1/4"	17	4 *	ER16M	E16M
EM161940IKFL	ER16	3/4"	40	13	G1/4"	17	2 / 4	ER16M	E16M
EM161950IK	ER16	3/4"	52	12	G1/8"	17	4 *	ER16M	E16M
EM161950IKFL	ER16	3/4"	51,5	13	G1/4"	17	2 / 4	ER16M	E16M

\* = ohne Spannfläche - without flat

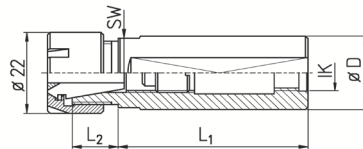
\* Ausverkaufsartikel - sellout article



Artikel-Nr. article-no.	Original-Nr. original-no.	Zange collet	D	L <sub>1</sub>	L <sub>2</sub>	IK / B ic / B	SW	Bild picture	Mutter nut	Schlüssel spanner
EM161972IKFL		ER16	3/4"	72	13	G1/4"	17	2 / 4	ER16M	E16M
EM161972IKWD		ER16	3/4"	72	13	G1/4"	17	4	ER16M	E16M
EM161972IK		ER16	3/4"	72	14	G1/4"	17	4 *	ER16M	E16M
EM1619100IKFL		ER16	3/4"	102	13	G1/4"	17	2 / 4	ER16M	E16M
EM1619100		ER16	3/4"	100	13	12	17	3 *	ER16M	E16M
EM1619120IK		ER16	3/4"	120	13	G1/8"	17	4 *	ER16M	E16M
* EM1619120FL		ER16	3/4"	120	15	11,5	17	2 / 3	ER16M	E16M
EM1619120IKWD		ER16	3/4"	121	13	G1/8"	17	4	ER16M	E16M
EM1619140		ER16	3/4"	140	13	11	17	3 *	ER16M	E16M
EM1619200		ER16	3/4"	203	12	-	17	1 *	ER16M	E16M
EM162038IK		ER16	20	38	16	G1/4"	17	4 *	ER16M	E16M
EM162038IKFL		ER16	20	38	16	G1/4"	17	2 / 4	ER16M	E16M
EM162050		ER16	20	50	13,5	11	17	3 *	ER16M	E16M
EM162050FL		ER16	20	50	14	11	17	2 / 3	ER16M	E16M
EM162070IK		ER16	20	70	16	11	17	3 *	ER16M	E16M
EM162070FL		ER16	20	70	13	11	17	2 / 3	ER16M	E16M
EM162070IKFL		ER16	20	70	13	G1/4"	17	2 / 4	ER16M	E16M
EM162070IKWD		ER16	20	70	15	G1/4"	17	4	ER16M	E16M
EM1620100FL		ER16	20	100	15	10	19	2 / 3	ER16M	E16M
EM1620100IKFL		ER16	20	100	16	G1/4"	17	2 / 4	ER16M	E16M
EM1620100IK		ER16	20	100	16	G1/4"	17	4 *	ER16M	E16M
EM1620100IKWD		ER16	20	100	16	G1/4"	17	4	ER16M	E16M
EM1620120		ER16	20	120	16	11	17	3 *	ER16M	E16M
EM1620120FL		ER16	20	120	15	10	17	2 / 3	ER16M	E16M
EM1620140		ER16	20	140	16	11	17	3 *	ER16M	E16M
EM1620140FL		ER16	20	140	16	11	17	2 / 3	ER16M	E16M
EM1620150IK		ER16	20	148	22	G1/8"	17	4 *	ER16M	E16M
EM1620150IKWD		ER16	20	148	22	G1/8"	17	4	ER16M	E16M
EM1620170FL		ER16	20	170	15	11	17	2 / 3	ER16M	E16M
EM1620170		ER16	20	170	15	12	17	3 *	ER16M	E16M
EM1620200		ER16	20	200	15	8	17	3 *	ER16M	E16M
EM1620200FL		ER16	20	200	15	8	17	2 / 3	ER16M	E16M
EM162238IKWD		ER16	22	38	16	G1/4"	19	4	ER16M	E16M
EM162246WD #	OT1-21	ER16	22	46	16	10,5	-	3	ER16M	E16M
EM162250WD		ER16	22	50	16	12	19	3	ER16M	E16M
EM162250IKWD	671-26	ER16	22	50	16	G1/8"	19	4	ER16M	E16M
EM162270IK		ER16	22	70	16	G1/4"	19	4 *	ER16M	E16M
EM162270IKFL		ER16	22	70	16	G1/4"	19	2 / 4	ER16M	E16M
EM162270IKWD	301-25-00	ER16	22	70	16	G1/4"	19	4	ER16M	E16M
EM162290IK		ER16	22	90	16	G1/4"	19	4 *	ER16M	E16M
EM162290IKWD		ER16	22	90	16	G1/8"	19	4	ER16M	E16M
EM1622100		ER16	22	100	16	-	19	1 *	ER16M	E16M
EM1622105IKWD	301-24-00	ER16	22	105	16	G1/8"	19	4	ER16M	E16M
EM1622114IKWD		ER16	22	114	16	G1/8"	19	4	ER16M	E16M
EM1622120IKFL	681-21	ER16	22	120	16	G1/8"	19	2 / 4	ER16M	E16M
EM1622120IK		ER16	22	120	16	G1/8"	19	4 *	ER16M	E16M
EM1622140IK		ER16	22	140	16	G1/8"	19	4 *	ER16M	E16M
EM1622140IKWD		ER16	22	140	16	G1/8"	19	4	ER16M	E16M
EM162370IKWD		ER16	23	70	16	G1/4"	19	4	ER16M	E16M

\* = ohne Spannfläche - without flat

# für STAR SR20RIV (mit Bund und Nut für Dichtring, Spannfläche schräg zulaufend)  
for STAR SR20RIV (with flange and groove for sealing, clamping flat aslope)

\* Ausverkaufsartikel - sellout article



Artikel-Nr. article-no.	Zange collet	D	L <sub>1</sub>	L <sub>2</sub>	IK / B ic / B	SW	Bild picture	Mutter nut	Schlüssel spanner
EM162560IK	ER16	25	60	16	G1/4"	22	4 *	ER16M	E16M
EM162560IKFL	ER16	25	60	16	G1/4"	22	2 / 4	ER16M	E16M
EM162560IKWD	ER16	25	60	16	G1/4"	22	4	ER16M	E16M
EM162575	ER16	25	75	16	-	22	1 *	ER16M	E16M
EM162575IK	ER16	25	75	16	G1/4"	22	4 *	ER16M	E16M
EM162575IKWD	ER16	25	75	16	G1/4"	22	4	ER16M	E16M
EM1625100IK	ER16	25	100	16	G1/4"	22	4 *	ER16M	E16M
EM1625100IKWD	ER16	25	100	16	G1/4"	22	4	ER16M	E16M
EM1625150IK	ER16	25	150	16	M14x1,5	22	4 *	ER16M	E16M
EM1625150IKTWD	ER16	25	150	16	M14x1,5	22	4	ER16M	E16M
EM162638WD	ER16	1"	38	16	12	22	3	ER16M	E16M
EM162638FL	ER16	1"	38	16	12	22	2 / 3	ER16M	E16M
* EM162638	ER16	1"	38	16	10	22	3 *	ER16M	E16M
EM162650IKFL	ER16	1"	50	16	G1/4"	22	2 / 4	ER16M	E16M
EM162660	ER16	1"	60	16	12	22	3 *	ER16M	E16M
EM162660FL	ER16	1"	60	16	12	22	2 / 3	ER16M	E16M
EM162660IKWD	ER16	1"	60	16	G1/4"	22	4	ER16M	E16M
EM162665FL	ER16	1"	65	16	12	22	2 / 3	ER16M	E16M
EM162672IKWD	ER16	1"	72	16	G1/4"	22	4	ER16M	E16M
EM162675IK	ER16	1"	75	16	G1/4"	22	4 *	ER16M	E16M
EM162675FL	ER16	1"	75	15	11,5	22	2 / 3	ER16M	E16M
EM162675IKWD	ER16	1"	75	16	10	22	3	ER16M	E16M
EM1626100IK	ER16	1"	100	16	G1/4"	22	4 *	ER16M	E16M
EM1626100FL	ER16	1"	100	15	12	22	2 / 3	ER16M	E16M
EM1626120FL	ER16	1"	120	16	12	22	2 / 3	ER16M	E16M
EM1626150IK	ER16	1"	150	16	G1/4"	22	4 *	ER16M	E16M
EM1626150IKWD	ER16	1"	150	16	G1/4"	22	4	ER16M	E16M
EM162890IKWD	ER16	28	90	16	M12x1	24	4	ER16M	E16M

\* = ohne Spannfläche - *without flat*

\* Ausverkaufsartikel - *sellout article*

## ER-Zangenspannfutter ER20M

## ER-Collet Holders ER20M

Ausführungen:  
Versions:

Vgl. auch S. 69 - 70  
See also page 69 - 70

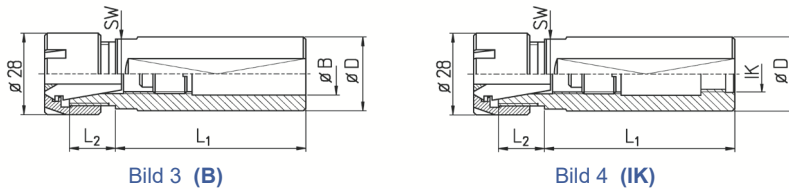
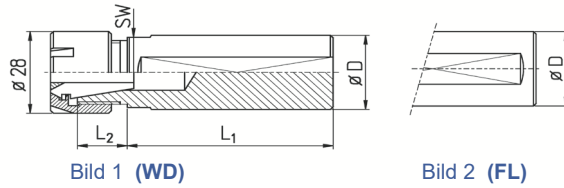

ER20M = M24 x 1

Abbildungen können abweichen - catalog drawings may differ

Artikel-Nr. article-no.	Original-Nr. original-no.	Zange collet	D	L <sub>1</sub>	L <sub>2</sub>	IK / B ic / B	SW	Bild picture	Mutter nut	Schlüssel spanner
EM2015100		ER20	15	100	32	-	22	1 *	ER20M	E20M
EM201650		ER20	16	50	32	11	22	3 *	ER20M	E20M
EM201650FL		ER20	16	50	32	11	22	2 / 3	ER20M	E20M
EM2016100		ER20	16	100	32	-	22	1 *	ER20M	E20M
EM2016100FL		ER20	16	100	32	-	22	1 / 2	ER20M	E20M
* EM201865		ER20	18	65	27	13,5	22	3 *	ER20M	E20M
EM201870		ER20	18	70	28	11	22	3 *	ER20M	E20M
EM201950		ER20	3/4"	50	25	12	22	3 *	ER20M	E20M
EM201950IK		ER20	3/4"	50	25	G1/4"	22	4 *	ER20M	E20M
EM201950FL		ER20	3/4"	50	25	12	22	2 / 3	ER20M	E20M
EM201970		ER20	3/4"	70	25	12	22	3 *	ER20M	E20M
EM201970IK		ER20	3/4"	70	25	G1/4"	22	4 *	ER20M	E20M
EM201970FL		ER20	3/4"	70	25	12	22	2 / 3	ER20M	E20M
EM201970IKFL		ER20	3/4"	70	25	G1/8"	22	2 / 4	ER20M	E20M
EM2019125IK		ER20	3/4"	125	25	G1/8"	22	4 *	ER20M	E20M
EM2019125IKWD		ER20	3/4"	125	25	G1/8"	22	4	ER20M	E20M
EM202050		ER20	20	50	25	14	22	3 *	ER20M	E20M
EM202050FL		ER20	20	50	25	13	22	2 / 3	ER20M	E20M
EM202064IKTWD		ER20	20	64	23	M12x1,5	22	4	ER20M	E20M
EM202085IK		ER20	20	85	25	M12x1,5	22	4 *	ER20M	E20M
EM202085IKTWD		ER20	20	85	25	M12x1,5	22	4	ER20M	E20M
EM2020100		ER20	20	100	26	11	22	3 *	ER20M	E20M
EM2020100FL		ER20	20	100	26	11	22	2 / 3	ER20M	E20M
EM2020110IKTWD		ER20	20	110	23	M12x1,5	22	4	ER20M	E20M
EM2020150IK		ER20	20	150	25	G1/4"	22	4 *	ER20M	E20M
EM2020150IKWD		ER20	20	150	25	G1/4"	22	4	ER20M	E20M
EM202270IK		ER20	22	70	25	G1/4"	22	4 *	ER20M	E20M
EM202270IKFL		ER20	22	70	25	G1/4"	22	2 / 4	ER20M	E20M
EM202270WD		ER20	22	70	25	14	22	3	ER20M	E20M
EM202270IKWD		ER20	22	70	25	G1/4"	22	4	ER20M	E20M
EM202290		ER20	22	90	25	12	22	3 *	ER20M	E20M
EM202290IKWD	451-22-00	ER20	22	90	22	G1/4"	22	4	ER20M	E20M

\* = ohne Spannfläche - without flat

\* Ausverkaufsartikel - sellout article

Artikel-Nr. article-no.	Original-Nr. original-no.	Zange collet	D	L <sub>1</sub>	L <sub>2</sub>	IK / B ic / B	SW	Bild picture	Mutter nut	Schlüssel spanner
EM202550FL		ER20	25	50	16	15	22	2 / 3	ER20M	E20M
EM202550		ER20	25	50	16	15	22	3 *	ER20M	E20M
EM202560WD		ER20	25	60	16	15	22	3	ER20M	E20M
EM202560IKWD		ER20	25	60	16	G1/4"	22	4	ER20M	E20M
EM202575		ER20	25	75	16	15	22	3 *	ER20M	E20M
EM202575FL		ER20	25	75	16	15	22	2 / 3	ER20M	E20M
EM2025100IK		ER20	25	100	16	G1/4"	22	4 *	ER20M	E20M
EM2025100IKWD		ER20	25	100	16	G1/4"	22	4	ER20M	E20M
EM2025100FL		ER20	25	100	17	15	22	2 / 3	ER20M	E20M
EM2025140IKFL		ER20	25	140	16	G1/4"	22	2 / 4	ER20M	E20M
EM2025140IK		ER20	25	140	16	G1/4"	22	4 *	ER20M	E20M
EM2025150IKWD		ER20	25	150	16	M14x1,5	22	4	ER20M	E20M
EM2025150IKT		ER20	25	150	16	M14x1,5	22	4 *	ER20M	E20M
EM2025170IKWD		ER20	25	169	16	M14x1,5	22	4	ER20M	E20M
EM2025200IK		ER20	25	200	16	M14x1,5	22	4 *	ER20M	E20M
EM2025200IKWD		ER20	25	200	16	M14x1,5	22	4	ER20M	E20M
EM202638		ER20	1"	38	16	13	22	3 *	ER20M	E20M
EM202638WD		ER20	1"	38	16	13	22	3	ER20M	E20M
EM202638FL		ER20	1"	38	16	13	22	2 / 3	ER20M	E20M
EM202638IKFL		ER10	1"	38	16	M14x1	22	4	ER20M	E20M
EM202670IKWD		ER20	1"	70	16	G1/4"	22	4	ER20M	E20M
EM202675IK		ER20	1"	75	16	G1/4"	22	4 *	ER20M	E20M
EM202675WD		ER20	1"	75	16	13	22	3	ER20M	E20M
EM202675IKFL		ER20	1"	75	16	G1/4"	22	2 / 4	ER20M	E20M
EM202682WD		ER20	1"	82	16	13	22	3	ER20M	E20M
EM202682IKWD		ER20	1"	82	16	G1/4"	22	3	ER20M	E20M
EM2026100FL		ER20	1"	100	16	12	22	2 / 3	ER20M	E20M
EM2026100IK		ER20	1"	100	16	G1/4"	22	4 *	ER20M	E20M
EM2026100IKWD		ER20	1"	100	16	G1/4"	22	4	ER20M	E20M
EM2026140FL		ER20	1"	140	17	15	22	2 / 3	ER20M	E20M
EM2026155IK		ER20	1"	155	17	M12x1,5	22	4 *	ER20M	E20M
EM2026155IKWD		ER20	1"	155	17	M12x1,5	22	4	ER20M	E20M
EM202890IKWD		ER20	28	90	16	M12x1,5	24	4	ER20M	E20M
EM203250IKWD		ER20	32	50	17	G1/4"	27	4	ER20M	E20M
EM203255IKWD	101-25 / 581-26	ER20	32	55	17	G1/4"	27	4	ER20M	E20M
EM203280		ER20	32	80	17	15	27	3 *	ER20M	E20M
EM203280IKWD	431-13-00	ER20	32	80	17	G1/8"	27	4	ER20M	E20M
EM203280WD		ER20	32	80	17	15	27	3	ER20M	E20M
EM203280IK		ER20	32	80	15	G1/4"	27	4 *	ER20M	E20M
EM2032100IK		ER20	32	100	18	G1/4"	27	4 *	ER20M	E20M
EM2032100IKWD	671-21-00 671-25-00	ER20	32	101	18	G1/4"	27	4	ER20M	E20M

\* = ohne Spannfläche - without flat

## ER-Zangenspannfutter ER25M

## ER-Collet Holders ER25M

Ausführungen:  
Versions:

Vgl. auch S. 69 - 70  
See also page 69 - 70

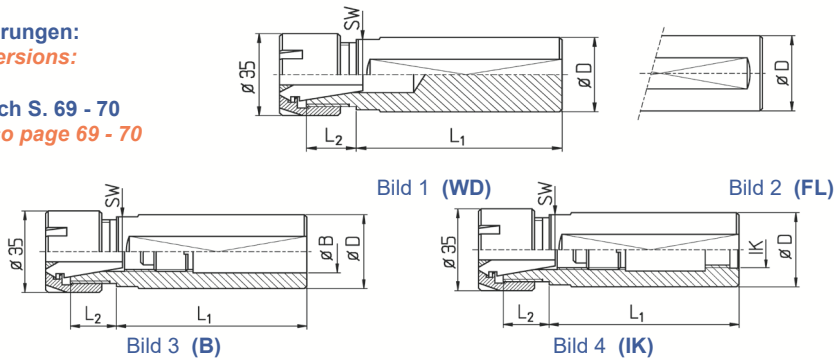

ER25M = M30 x 1

Abbildungen können abweichen - catalog drawings may differ

Artikel-Nr. article-no.	Original-Nr. original-no.	Zange collet	D	L <sub>1</sub>	L <sub>2</sub>	IK / B ic / B	SW	Bild picture	Mutter nut	Schlüssel spanner
EM251350		ER25	13	50	35	-	27	1 *	ER25M	E25M
EM2516100FL		ER25	16	100	36	-	27	1 / 2	ER25M	E25M
EM2516100		ER25	16	100	36	-	27	1 *	ER25M	E25M
EM251950		ER25	3/4"	50	33	12	27	3 *	ER25M	E25M
EM251950FL		ER25	3/4"	50	33	12	27	2 / 3	ER25M	E25M
EM251970		ER25	3/4"	70	33	13	27	3 *	ER25M	E25M
EM251974		ER25	3/4"	74	33	13	27	3 *	ER25M	E25M
* EM251974WD		ER25	3/4"	74	33	13	27	3	ER25M	E25M
EM252050IK		ER25	20	50	33	G1/4"	27	4 *	ER25M	E25M
EM252050FL		ER25	20	50	33	14	27	2 / 3	ER25M	E25M
EM252075FL		ER25	20	75	33	14	27	2 / 3	ER25M	E25M
EM2520100		ER25	20	100	34	11	27	3 *	ER25M	E25M
EM2520100FL		ER25	20	100	34	11,5	27	2 / 3	ER25M	E25M
EM2520150IK		ER25	20	150	33	G1/4"	27	4 *	ER25M	E25M
EM2520150IKFL		ER25	20	150	33	G1/4"	27	2 / 4	ER25M	E25M
EM252275IK		ER25	22	75	27	G1/4"	27	4 *	ER25M	E25M
EM252275FL		ER25	22	75	27	14	27	2 / 3	ER25M	E25M
EM252275IKFL		ER25	22	75	27	G1/4"	27	2 / 4	ER25M	E25M
EM252550IK		ER25	25	50	27	G1/4"	27	4 *	ER25M	E25M
EM252550FL		ER25	25	50	27	18	27	2 / 3	ER25M	E25M
EM252575		ER25	25	75	27	17	27	3 *	ER25M	E25M
EM252575FL		ER25	25	75	27	18	27	2 / 3	ER25M	E25M
EM2525100IKT		ER25	25	100	27	G1/4"	27	4 *	ER25M	E25M
EM2525100WD		ER25	25	100	27	18	27	3	ER25M	E25M
EM2525100FL		ER25	25	100	27	18	27	2 / 3	ER25M	E25M
EM2525100IKWD		ER25	25	100	27	G1/4"	27	4	ER25M	E25M
EM2525150IK		ER25	25	150	27	M14x1,5	27	4 *	ER25M	E25M
EM2525150IKTWD		ER25	25	150	27	M14x1,5	27	4	ER25M	E25M
EM2525180IK		ER25	25	180	27	G1/4"	27	4 *	ER25M	E25M
EM2525180IKWD		ER25	25	180	27	G1/4"	27	4	ER25M	E25M
EM252675IKWD		ER25	1"	75	27	G1/4"	27	4	ER25M	E25M
EM252675FL		ER25	1"	75	27	18	27	2 / 3	ER25M	E25M
EM252675IKFL		ER25	1"	75	27	G1/4"	27	2 / 4	ER25M	E25M
EM2526100FL		ER25	1"	100	27	14	27	2 / 3	ER25M	E25M
EM2526150WD		ER25	1"	150	27	14	27	3	ER25M	E25M
EM252890IKWD		ER25	28	90	17	M12x1,5	24	4	ER25M	E25M
EM2530150		ER25	30	150	14,5	19	27	3 *	ER25M	E25M
EM2530150FL		ER25	30	150	14	18	27	2 / 3	ER25M	E25M
EM2530180		ER25	30	180	14	18	27	3 *	ER25M	E25M
EM2530180FL		ER25	30	180	14	18	27	2 / 3	ER25M	E25M
EM253250WD	581-23	ER25	32	50	24	18	-	3	ER25M	E25M
EM253262WD	101-26	ER25	32	62	16	18	27	3	ER25M	E25M
EM253280IKWD		ER25	32	80	16	G1/4"	27	4	ER25M	E25M
EM2532180		ER25	32	179	16	18	27	3 *	ER25M	E25M
EM2532180FL		ER25	32	180	16	18	27	2 / 3	ER25M	E25M

\* = ohne Spannfläche - without flat

\* Ausverkaufsartikel - sellout article

## ER-Zangenspannfutter ER11

## ER-Collet Holders ER11

Ausführungen:

Versions:

Vgl. auch S. 69 - 70

See also page 69 - 70



Bild 1 (WD)

Bild 2 (FL)



Bild 3 (B)

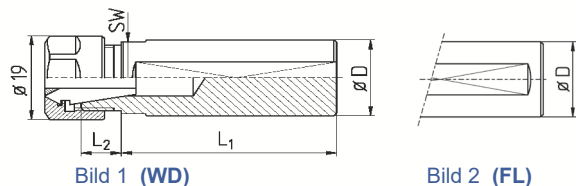

Bild 4 (IK)

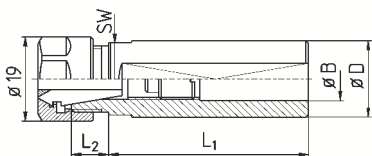

UM/ER11 = M14 x 0,75

Abbildungen können abweichen - catalog drawings may differ

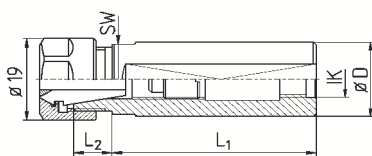
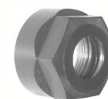
Artikel-Nr. article-no.	Original-Nr. original-no.	Zange collet	D	L <sub>1</sub>	L <sub>2</sub>	IK / B ic / B	SW	Bild picture	Mutter nut	Schlüssel spanner
EU110865		ER11	8	66	21	-	11	1 *	UM/ER11	GS17
EU1110150		ER11	10	150	22	-	12	1 *	UM/ER11	GS17
EU1111370		ER11	1/2"	70	23	-	12	1 *	UM/ER11	GS17
EU111428		ER11	14	28	10	7	12	3 *	UM/ER11	GS17
EU111465		ER11	14	64	9	6	-	3 *	UM/ER11	GS17
EU1118310		ER11	18	310	12	-	15	1 *	UM/ER11	GS17
EU111930WD		ER11	3/4"	29	8	7	17	3	UM/ER11	GS17
EU111940IK		ER11	3/4"	38	10	G1/8"	17	4 *	UM/ER11	GS17
EU111940IKWD		ER11	3/4"	38	10	G1/8"	17	4	UM/ER11	GS17
EU111950		ER11	3/4"	50	12	8	17	3 *	UM/ER11	GS17
EU111955WD		ER11	3/4"	55	12	7	17	3	UM/ER11	GS17
EU111960WD		ER11	3/4"	60	12	9	17	3	UM/ER11	GS17
EU111970IKWD		ER11	3/4"	70	12	G1/8"	17	4	UM/ER11	GS17
EU1119125IK		ER11	3/4"	125	12	G1/8"	17	4 *	UM/ER11	GS17
EU1119125IKWD		ER11	3/4"	125	12	G1/8"	17	4	UM/ER11	GS17
EU112030WD		ER11	20	30	11	7	17	3	UM/ER11	GS17
EU112050WD		ER11	20	50	12	8,5	17	3	UM/ER11	GS17
EU112060		ER11	20	60	12	8,5	17	3 *	UM/ER11	GS17
EU112060WD		ER11	20	60	12	8,5	17	3	UM/ER11	GS17
EU112080WD		ER11	20	80	12	10,5	17	3	UM/ER11	GS17
EU1120100		ER11	20	100	12	11	17	3 *	UM/ER11	GS17
EU1120100FL		ER11	20	100	12	11	17	2 / 3	UM/ER11	GS17
EU1120145IK		ER11	20	145	12	G1/8"	16	4 *	UM/ER11	GS17
EU1120170		ER11	20	170	11	-	17	1 *	UM/ER11	GS17
EU1120245		ER11	20	245	13	-	17	1 *	UM/ER11	GS17
EU1120300		ER11	20	300	13	-	17	1 *	UM/ER11	GS17
EU112270IK		ER11	22	70	13	G1/4"	19	4 *	UM/ER11	GS17
EU112270IKFL	301-22-00	ER11	22	70	13	G1/4"	19	2 / 4	UM/ER11	GS17
EU112290IK		ER11	22	90	12	G1/4"	19	4 *	UM/ER11	GS17
EU112290IKFL		ER11	22	90	12	G1/4"	19	2 / 4	UM/ER11	GS17
EU112290IKWD	301-21-00	ER11	22	90	12	G1/4"	19	4	UM/ER11	GS17
EU112570IK		ER11	25	70	12	G1/4"	22	4 *	UM/ER11	GS17
EU112570WD		ER11	25	70	12	7	22	3	UM/ER11	GS17
EU112585		ER11	25	85	12	11	22	3 *	UM/ER11	GS17
EU112585IK		ER11	25	85	12	G1/4"	22	4 *	UM/ER11	GS17
EU112585WD		ER11	25	85	12	11	22	3	UM/ER11	GS17
EU112673WD		ER11	1"	73	12	10	22	3	UM/ER11	GS17
EU112675IKWD		ER11	1"	75	12	G1/4"	22	4	UM/ER11	GS17

\* = ohne Spannfläche - without flat

## ER-Zangenspannfutter ER16

## ER-Collet Holders ER16

Ausführungen:

Versions:

Vgl. auch S. 69 - 70

See also page 69 - 70



Bild 1 (WD)

Bild 2 (FL)



Bild 3 (B)

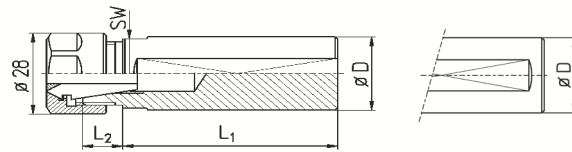

Bild 4 (IK)

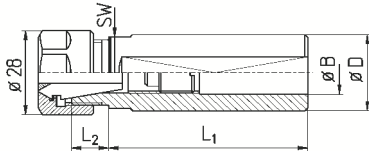

UM/ER16 = M22 x 1,5

Abbildungen können abweichen - catalog drawings may differ

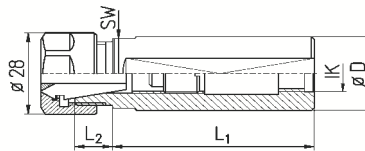
Artikel-Nr. article-no.	Original-Nr. original-no.	Zange collet	D	L <sub>1</sub>	L <sub>2</sub>	IK / B ic / B	SW	Bild picture	Mutter nut	Schlüssel spanner
EU161060		ER16	10	60	27	-	19	1 *	UM/ER16	GS25
EU161240		ER16	12	40	25	6	19	3 *	UM/ER16	GS25
EU1613100		ER16	1/2"	100	27	8	19	3 *	UM/ER16	GS25
EU161460		ER16	14	60	27	8,5	19	3 *	UM/ER16	GS25
EU161550		ER16	15	50	25	8,5	19	3 *	UM/ER16	GS25
EU165860		ER16	5/8"	60	25	10	19	3 *	UM/ER16	GS25
EU161660		ER16	16	60	25	10	19	3 *	UM/ER16	GS25
EU161660FL		ER16	16	60	25	10	19	2 / 3	UM/ER16	GS25
EU161940IK		ER16	3/4"	39	15	G1/4"	17	4 *	UM/ER16	GS25
EU161938WD		ER16	3/4"	38	25	11	19	3	UM/ER16	GS25
EU161945		ER16	3/4"	46	13	11,5	-	3 *	UM/ER16	GS25
EU161950		ER16	3/4"	50	22	10	19	3 *	UM/ER16	GS25
EU161950FL		ER16	3/4"	50	25	11	19	2 / 3	UM/ER16	GS25
EU161955		ER16	3/4"	55	15	11	17	3 *	UM/ER16	GS25
EU161950WD		ER16	3/4"	50	15	11	17	3	UM/ER16	GS25
EU1619100		ER16	3/4"	100	25	11	19	3 *	UM/ER16	GS25
EU162050		ER16	20	50	22	11	19	3 *	UM/ER16	GS25
EU162050FL		ER16	20	50	22	11	19	2 / 3	UM/ER16	GS25
EU162075WD		ER16	20	73	12	11	17	3	UM/ER16	GS25
EU1620100FL		ER16	20	100	24	11	19	2 / 3	UM/ER16	GS25
EU1620100		ER16	20	100	14	12	19	3 *	UM/ER16	GS25
EU162235SO		ER16	22	35	13	G 1/4"	19	4	UM/ER16	GS25
EU162255IKWD	736-21-00	ER16	22	54	12	G1/4"	19	4	UM/ER16	GS25
EU1622105OSWD		ER16	22	105	12	10	19	4	UM/ER16	GS25
EU1622105WD		ER16	22	103	12	10	19	3	UM/ER16	GS25
EU162560IKFL		ER16	25	60	16	G1/4"	22	2 / 4	UM/ER16	GS25
EU162575WD		ER16	25	75	16	12	22	3	UM/ER16	GS25
EU1625100FL		ER16	25	100	16	11	22	2 / 3	UM/ER16	GS25
EU1625125IK		ER16	25	125	16	G1/4"	22	4 *	UM/ER16	GS25
EU1625125IKWD		ER16	25	125	16	G1/4"	22	4	UM/ER16	GS25
EU1625150IK		ER16	25	150	16	G1/4"	22	4 *	UM/ER16	GS25
EU1625150IKWD		ER16	25	150	16	G1/4"	22	4	UM/ER16	GS25
EU1625220		ER16	25	220	23	-	19	1 *	UM/ER16	GS25
EU1625220WD		ER16	25	220	23	-	19	1	UM/ER16	GS25

\* = ohne Spannfläche - without flat

Artikel-Nr. article-no.	Original-Nr. original-no.	Zange collet	D	L <sub>1</sub>	L <sub>2</sub>	IK / B ic / B	SW	Bild picture	Mutter nut	Schlüssel spanner
EU162638		ER16	1"	38	16	12	22	3 *	UM/ER16	GS25
EU162638WD		ER16	1"	38	16	12	22	3	UM/ER16	GS25
EU162638FL		ER16	1"	38	16	12	22	2 / 3	UM/ER16	GS25
EU162660		ER16	1"	60	16	12	22	3 *	UM/ER16	GS25
EU162660IKWD		ER16	1"	60	16	G1/4"	22	4	UM/ER16	GS25
EU162660FL		ER16	1"	58	16	12	22	2 / 3	UM/ER16	GS25
EU162675		ER16	1"	75	16	12	22	3 *	UM/ER16	GS25
EU162675IKWD		ER16	1"	75	16	G1/4"	22	4	UM/ER16	GS25
EU1626100		ER16	1"	100	16	12	22	3 *	UM/ER16	GS25
EU1626100FL		ER16	1"	100	16	11	22	2 / 3	UM/ER16	GS25
EU1626124WD		ER16	1"	124	16	11	22	3	UM/ER16	GS25
* EU163220WD		ER16	32	20	16	10	-	3	UM/ER16	GS25
* EU163240WD		ER16	32	40	16	12	-	3	UM/ER16	GS25
EU163260IK		ER16	32	60	16	G1/4"	27	4 *	UM/ER16	GS25
EU163260IKFL	781-25	ER16	32	60	16	G1/4"	27	2 / 4	UM/ER16	GS25
EU163260FL		ER16	32	60	16	12	27	2 / 3	UM/ER16	GS25
EU164060FL		ER16	40	60	25	11	-	2 / 3	UM/ER16	GS25

\* = ohne Spannfläche - without flat

\* Ausverkaufsartikel - sellout article



## ER-Zangenspannfutter ER20

## ER-Collet Holders ER20

Ausführungen:  
Versions:

Vgl. auch S. 69 - 70  
See also page 69 - 70



Bild 1 (WD)



Bild 2 (FL)

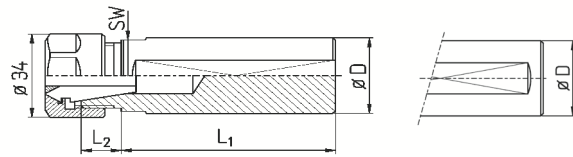

Bild 3 (B)

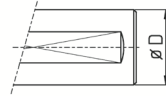

Bild 4 (IK)

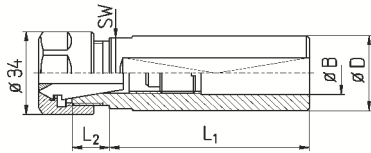

UM/ER20 = M25 x 1,5

Abbildungen können abweichen - catalog drawings may differ

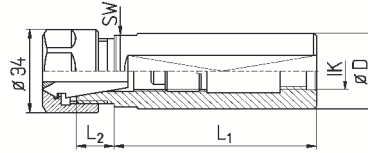
Artikel-Nr. article-no.	Zange collet	D	L <sub>1</sub>	L <sub>2</sub>	IK / B ic / B	SW	Bild picture	Mutter nut	Schlüssel spanner
EU2013100	ER20	1/2"	100	35	-	-	1 *	UM/ER20	GS30
EU2058100	ER20	5/8"	100	35	-	-	1 *	UM/ER20	GS30
EU201936	ER20	3/4"	36	17	13	-	3 *	UM/ER20	GS30
EU201938	ER20	3/4"	38	16	13	-	3 *	UM/ER20	GS30
EU201950	ER20	3/4"	50	22	13	22	3 *	UM/ER20	GS30
EU201950K	ER20	3/4"	50	15	14	-	3 *	UM/ER20	GS30
EU202030	ER20	20	30	25	13	22	3 *	UM/ER20	GS30
EU202050	ER20	20	50	25	14	22	3 *	UM/ER20	GS30
EU202050KFL	ER20	20	50	17	14	-	2 / 3	UM/ER20	GS30
EU202055IK	ER20	20	54	22	G1/4"	22	3 *	UM/ER20	GS30
EU202060FL	ER20	20	60	25	13	22	2 / 3	UM/ER20	GS30
EU202060	ER20	20	60	22	13	22	3 *	UM/ER20	GS30
* EU202085IKWD	ER20	20	85	25	M12 x 1,5	22	4	UM/ER20	GS30
EU2020100	ER20	20	100	25	13	22	3 *	UM/ER20	GS30
EU2020100FL	ER20	20	100	25	13	22	2 / 3	UM/ER20	GS30
* EU2022100WD	ER20	22	104	13	12	19	3	UM/ER20	GS30
EU2025100IK	ER20	25	102	14	G1/4"	22	4 *	UM/ER20	GS30
EU2025100IKWD	ER20	25	102	14	G1/4"	22	4	UM/ER20	GS30
EU2025145IKFL	ER20	25	143	13	G1/4"	22	2 / 4	UM/ER20	GS30
EU202638	ER20	1"	38	16	16	22	3 *	UM/ER20	GS30
EU202638FL	ER20	1"	38	16	13	22	2 / 3	UM/ER20	GS30
EU202685WD	ER20	1"	83	14	13	22	3	UM/ER20	GS30
EU2026100IK	ER20	1"	100	16	G1/4"	22	4 *	UM/ER20	GS30

\* = ohne Spannfläche - without flat

\* Ausverkaufsartikel - sellout article

## ER-Zangenspannfutter ER25

## ER-Collet Holders ER25

Ausführungen:

Versions:

Vgl. auch S. 69 - 70

See also page 69 - 70



Bild 1 (WD)

Bild 2 (FL)



Bild 3 (B)

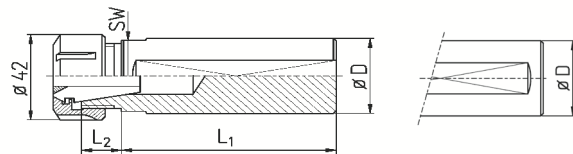

Bild 4 (IK)

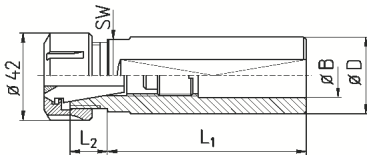

UM/ER25 = M32 x 1,5

Abbildungen können abweichen - catalog drawings may differ

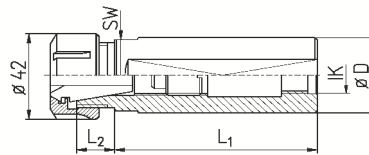
Artikel-Nr. article-no.	Zange collet	D	L <sub>1</sub>	L <sub>2</sub>	IK / B ic / B	SW	Bild picture	Mutter nut	Schlüssel spanner
EU2516100	ER25	16	100	36	-	27	1 *	UM/ER25	E25
EU2516100FL	ER25	16	100	36	-	27	1 / 2	UM/ER25	E25
EU251950	ER25	3/4"	50	33	13	27	3 *	UM/ER25	E25
EU251950FL	ER25	3/4"	50	33	13	27	2 / 3	UM/ER25	E25
EU2519100	ER25	3/4"	100	33	13	27	3 *	UM/ER25	E25
EU252050	ER25	20	50	33	14	27	3 *	UM/ER25	E25
EU252050oB	ER25	20	50	33	-	27	1 *	UM/ER25	E25
EU252050FL	ER25	20	50	33	14	27	2 / 3	UM/ER25	E25
EU2520100	ER25	20	100	33	11	27	3 *	UM/ER25	E25
EU2520100FL	ER25	20	100	33	11	27	2 / 3	UM/ER25	E25
EU252550	ER25	25	50	27	18	27	3 *	UM/ER25	E25
EU252550FL	ER25	25	50	27	18	27	2 / 3	UM/ER25	E25
EU252550K	ER25	25	50	20	17	-	3 *	UM/ER25	E25
EU2525100	ER25	25	100	27	14	27	3 *	UM/ER25	E25
EU2525100WD	ER25	25	100	27	14	27	3	UM/ER25	E25
EU2525150IK	ER25	25	150	27	G1/4"	27	4 *	UM/ER25	E25
EU2525150IKWD	ER25	25	150	27	G1/4"	27	4	UM/ER25	E25
EU2525150FL	ER25	25	150	27	14	27	2 / 3	UM/ER25	E25
EU252650	ER25	1"	50	27	18	27	3 *	UM/ER25	E25
EU252660WD	ER25	1"	60	27	18	27	3	UM/ER25	E25
EU2526100	ER25	1"	100	27	14	27	3 *	UM/ER25	E25
EU2526100FL	ER25	1"	100	27	14	27	2 / 3	UM/ER25	E25
EU253060	ER25	30	60	27	18	27	3 *	UM/ER25	E25
EU253060FL	ER25	30	60	27	16	27	2 / 3	UM/ER25	E25
EU253185	ER25	1 1/4"	85	15	18	27	3 *	UM/ER25	E25
* EU2531180	ER25	1 1/4"	180	14	18	27	3 *	UM/ER25	E25
* EU2531180FL	ER25	1 1/4"	180	14	18	27	2 / 3	UM/ER25	E25
EU253275	ER25	32	75	15	18	-	3 *	UM/ER25	E25
EU2532110	ER25	32	110	14	17	27	3 *	UM/ER25	E25
EU2532115FL	ER25	32	115	14	18	27	2 / 3	UM/ER25	E25
EU2532180	ER25	32	180	14	18	27	3 *	UM/ER25	E25
EU2532180FL	ER25	32	180	14	18	27	2 / 3	UM/ER25	E25
EU254080	ER25	40	80	18	19	36	3 *	UM/ER25	E25
EU255082WD	ER25	50	82	18	-	-	1	UM/ER25	E25

\* = ohne Spannfläche - without flat

\* Ausverkaufsartikel - sellout article

## ER-Zangenspannfutter ER32

## ER-Collet Holders ER32

Ausführungen:

Versions:

Vgl. auch S. 69 - 70

See also page 69 - 70



Bild 1 (WD)



Bild 2 (FL)

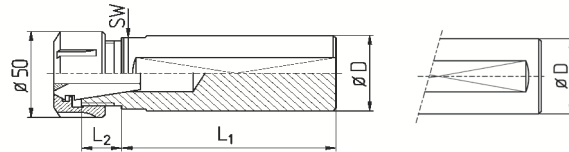

Bild 3 (B)

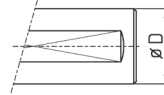

Bild 4 (IK)

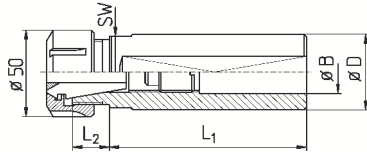

UM/ER32 = M40 x 1,5

Abbildungen können abweichen - catalog drawings may differ

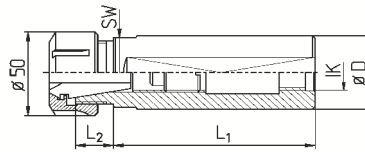
Artikel-Nr. article-no.	Zange collet	D	L <sub>1</sub>	L <sub>2</sub>	IK / B ic / B	SW	Bild picture	Mutter nut	Schlüssel spanner
EU321950	ER32	3/4"	50	40	13	36	3 *	UM/ER32	E32
EU3219100	ER32	3/4"	100	40	13	36	3 *	UM/ER32	E32
EU322050	ER32	20	50	40	13	36	3 *	UM/ER32	E32
EU322050FL	ER32	20	50	40	13	36	2 / 3	UM/ER32	E32
EU3220100	ER32	20	100	40	13	36	3 *	UM/ER32	E32
EU3220100FL	ER32	20	100	40	13	36	2 / 3	UM/ER32	E32
EU322550	ER32	25	50	40	18	36	3 *	UM/ER32	E32
EU322550FL	ER32	25	50	40	18	36	2 / 3	UM/ER32	E32
EU3225100	ER32	25	100	40	17	36	3 *	UM/ER32	E32
EU3225100FL	ER32	25	100	40	17	36	2 / 3	UM/ER32	E32
EU322650	ER32	1"	50	40	18	36	3 *	UM/ER32	E32
EU3226100	ER32	1"	100	40	16	36	3 *	UM/ER32	E32
* EU323060WD	ER32	30	60	27	18	36	3	UM/ER32	E32
EU323065FL	ER32	30	64	25	21	-	2 / 3	UM/ER32	E32
EU323160	ER32	1 1/4"	60	27	20	36	3 *	UM/ER32	E32
EU323260	ER32	32	60	27	22	36	3 *	UM/ER32	E32
EU3232100FL	ER32	32	100	27	20	36	2 / 3	UM/ER32	E32
EU324070FL	ER32	40	70	17	23	36	2 / 3	UM/ER32	E32
EU324080	ER32	40	84	16	23	36	3 *	UM/ER32	E32
EU3240130	ER32	40	130	17	23	36	3 *	UM/ER32	E32
EU3240130FL	ER32	40	131	15	23	36	2 / 3	UM/ER32	E32
EU3240150	ER32	40	153	17	25	36	3 *	UM/ER32	E32
EU3240210	ER32	40	210	19	25	-	3 *	UM/ER32	E32

\* = ohne Spannfläche - without flat

\* Ausverkaufsartikel - sellout article

## ER-Zangenspannfutter ER40

## ER-Collet Holders ER40

Ausführungen:

Versions:

Vgl. auch S. 69 - 70

See also page 69 - 70



Bild 2 (FL)



Bild 3 (B)

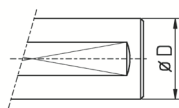

UM/ER40 = M50 x 1,5

Abbildungen können abweichen - catalog drawings may differ

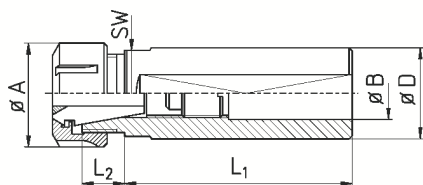
Artikel-Nr. article-no.	Zange collet	D	L <sub>1</sub>	L <sub>2</sub>	A	IK / B ic / B	SW	Bild picture	Mutter nut	Schlüssel spanner
EU401960	ER40	3/4"	60	43	63	11	46	3 *	UM/ER40	E40
EU402060	ER40	20	60	43	63	12	46	3 *	UM/ER40	E40
EU402550	ER40	25	50	43	63	17	46	3 *	UM/ER40	E40
EU402550FL	ER40	25	50	45	63	18	46	2 / 3	UM/ER40	E40
EU402650	ER40	1"	50	45	63	18	46	3 *	UM/ER40	E40
EU403160	ER40	1 1/4"	60	43	63	23	46	3 *	UM/ER40	E40
EU403260	ER40	32	60	43	63	22	46	3 *	UM/ER40	E40
EU403275	ER40	32	75	43	63	24	41	3 *	UM/ER40	E40
EU403680	ER40	36	80	43	63	23	46	3 *	UM/ER40	E40
EU404080	ER40	40	80	44	63	28	46	3 *	UM/ER40	E40
EU404080FL	ER40	40	80	44	63	28	46	2 / 3	UM/ER40	E40
EU4040200	ER40	40	200	44	63	26	46	3 *	UM/ER40	E40
EU4040200TR	ER40	40	200	26	63	25	36	3 *	UM/ER40	E40
EU4045100WD	ER40	45	100	20	63	31,5	-	3	UM/ER40	E40
EU4050160	ER40	50	160	18	63	25	46	3 *	UM/ER40	E40
EU4050195	ER40	50	195	27	63	25	-	3 *	UM/ER40	E40

\* = ohne Spannfläche - without flat

## Pinolenanschläge für Bohrpinoles, Bohrverlängerungen

## Collet Holder Stops for Pre Setting



Bild 1



Bild 2

Artikel-Nr. article-no.	B	A	C	Bild picture
EM-PA16	16	23,5	7	1
EM-PA19	3/4"	23	8	1
EM-PA20	20	23	8	1
EM-PA22	22	25	8	1
* EM-PA22B	22	34	8	2
EM-PA25	25	30	8	1
EM-PA26	1"	30	8	1
* EM-PA32	32	40	8	1

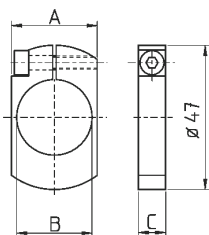
\* Ausverkaufsartikel

\* sellout article

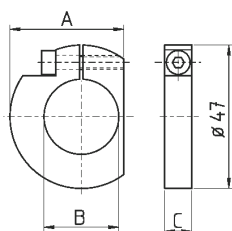
## ER-Zangenspannfutter mit seitlichem und rückseitigem Kühlmittelanschluss

**ER-Collet Holders**  
with Inner Coolant,  
Side and Rear

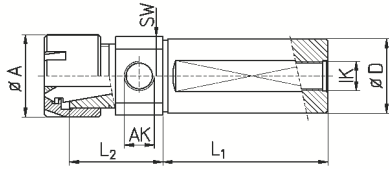

ERC16M = M19 x 1

ERC20M = M24 x 1

ERC25M = M30 x 1

Lieferung inkl. Mutter für Dichtscheiben - supplied with nut for sealing disks

Artikel-Nr. article-no.	Zange collet	D	L <sub>1</sub>	L <sub>2</sub>	A	AK	IK	Mutter nut	Schlüssel spanner
EM161650AK1WD	ER16	16	50	30	22	G1/8"	M8x1	ERC16M	E16M
EM1618310AK1	ER16	18	310	35	22	G1/8"	-	ERC16M	E16M
EM161930AK1WD	ER16	3/4"	30	30	22	G1/8"	G1/8"	ERC16M	E16M
EM161950AK1WD	ER16	3/4"	50	30	22	G1/8"	G1/8"	ERC16M	E16M
EM161960AK0WD	ER16	3/4"	60	30	22	M12x1,5	G1/8"	ERC16M	E16M
EM161960AK1WD	ER16	3/4"	60	30	22	G1/8"	G1/8"	ERC16M	E16M
EM161960AK1	ER16	3/4"	60	27	22	G1/8"	G1/8"	ERC16M	E16M
EM161970AK1WD	ER16	3/4"	70	27	22	G1/8"	G1/8"	ERC16M	E16M
EM1619100AK1WD	ER16	3/4"	100	27	22	G1/8"	G1/8"	ERC16M	E16M
EM162050AK0WD	ER16	20	50	30	22	M12x1,5	G1/8"	ERC16M	E16M
EM162050AK1WD	ER16	20	50	27	22	G1/8"	G1/8"	ERC16M	E16M
EM162070AK0WD	ER16	20	70	30	22	M12x1,5	G1/8"	ERC16M	E16M
EM162070AK1WD	ER16	20	70	27	22	G1/8"	G1/8"	ERC16M	E16M
EM1620310AK1	ER16	20	310	35	22	G1/8"	--	ERC16M	E16M
EM162250AK0WD	ER16	22	50	30	22	M12x1,5	M12x1,5	ERC16M	E16M
EM162250AK1WD	ER16	22	50	27	22	G1/8"	G1/8"	ERC16M	E16M
EM162250AK3WD	ER16	22	50	30	22	M10x1	M12x1,75	ERC16M	E16M
EM162270AK0WD	ER16	22	70	30	22	M12x1,5	M12x1,75	ERC16M	E16M
EM162270AK1WD	ER16	22	70	27	22	G1/8"	G1/8"	ERC16M	E16M
EM162270AK2WD	ER16	22	70	27	22	M8x1	G1/8"	ERC16M	E16M
EM162270AK3WD	ER16	22	70	30	22	M10x1	M12x1,75	ERC16M	E16M
EM162550AK0WD	ER16	25	50	30	22	M12x1,5	G1/4"	ERC16M	E16M
EM162550AK1WD	ER16	25	50	27	22	G1/8"	G1/4"	ERC16M	E16M
EM162550AK2WD	ER16	25	50	26	22	M8x1	G1/4"	ERC16M	E16M
EM162570AK0WD	ER16	25	70	32	22	M12x1,5	G1/4"	ERC16M	E16M
EM162570AK1WD	ER16	25	70	30	22	G1/8"	G1/4"	ERC16M	E16M

# ER-Zangenspannfutter / ER-Collet Holders

Artikel-Nr. article-no.	Zange collet	D	L <sub>1</sub>	L <sub>2</sub>	A	AK	IK	Mutter nut	Schlüssel spanner
EM162650AK0WD	ER16	1"	50	30	22	M12x1,5	G1/4"	ERC16M	E16M
EM162650AK1WD	ER16	1"	50	30	22	G1/8"	G1/4"	ERC16M	E16M
EM162660AK0WD	ER16	1"	60	30	22	M12x1,5	M12x1,75	ERC16M	E16M
EM162660AK1WD	ER16	1"	60	30	22	G1/8"	M12x1,75	ERC16M	E16M
EM162670AK0WD	ER16	1"	70	30	22	M12x1,5	G1/8"	ERC16M	E16M
EM162670AK1WD	ER16	1"	70	27	22	G1/8"	G1/8"	ERC16M	E16M
EM162670AK2WD	ER16	1"	70	30	22	M8x1	G1/4"	ERC16M	E16M
EM202250AK0WD	ER20	22	50	34	28	M12x1,5	G1/8"	ERC20M	E20M
EM2025132AK1WD	ER20	25	132	34	28	G1/8"	G1/4"	ERC20M	E20M
EM202550AK1WD	ER20	25	50	34	28	G1/8"	G1/4"	ERC20M	E20M
EM202550AK2WD	ER20	25	50	34	28	M8x1	G1/4"	ERC20M	E20M
EM202650AK1WD	ER20	1"	50	34	28	G1/8"	G1/4"	ERC20M	E20M
EM202650AK2WD	ER20	1"	50	34	28	M8x1	G1/4"	ERC20M	E20M
EM2525137AK1WD	ER25	25	137	40	35	G1/8"	M12x1,5	ERC25M	E25M

## ER-Zangenspannfutter mit seitlichem Kühlmittelanschluss

## ER-Collet Holders with Side Coolant Inlet

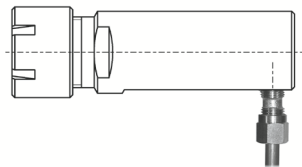
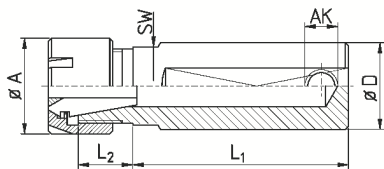

ERC16M = M19 x 1

Artikel-Nr. article-no.	Zange collet	D	L <sub>1</sub>	L <sub>2</sub>	A	SW	AK ic	Mutter nut	Schlüssel spanner
* EM162260WDAKS1	ER 16	22	60	16	22	19	G1/8"	ERC16M	E16M
EM162270WDAKS1	ER 16	22	70	16	22	19	G1/8"	ERC16M	E16M
EM162280WDAKS1	ER 16	22	80	16	22	19	G1/8"	ERC16M	E16M

\* Ausverkaufsartikel

\* sellout article

## CNC Zangenspannfutter mit Klemmfläche - für innere Kühlmittelzufuhr

## CNC Collet Holders with Clamping Flat - Inner Coolant

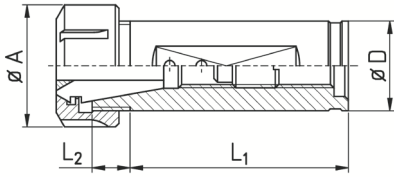

Artikel-Nr. article-no.	Zange collet	D	A	L <sub>1</sub>	L <sub>2</sub>	Mutter nut	Schlüssel spanner
EU253275FL-CNC	ER 25	32	42	75	14	UM/ER 25	E25
EU254080FL-CNC	ER 25	40	42	80	18	UM/ER 25	E25
EU323260FL-CNC	ER 32	32	50	60	27	UM/ER 32	E32
EU324080FL-CNC	ER 32	40	50	80	18	UM/ER 32	E32
* EU3245100FL-CNC	ER 32	45	50	100	20	UM/ER 32	E32
EU3250120FL-CNC	ER 32	50	50	120	20	UM/ER 32	E32
* EU403260FL-CNC	ER 40	32	63	60	43	UM/ER 40	E40
EU404075FL-CNC	ER 40	40	63	75	32	UM/ER 40	E40
* EU4045100FL-CNC	ER 40	45	63	100	20	UM/ER 40	E40
* EU4050120FL-CNC	ER 40	50	63	120	18	UM/ER 40	E40

\* Ausverkaufsartikel

\* sellout article



UM/ER25 = M32 x 1,5

UM/ER32 = M40 x 1,5

UM/ER40 = M50 x 1,5

## ER-Zangenspannfutter für STAR / MAIER-Maschinen / Rückseite

## ER-Collet Holders for STAR / MAIER-Machines / Backworking

Bild 1



Bild 2



ER11M = M13 x 0,75

ER16M = M19 x 1

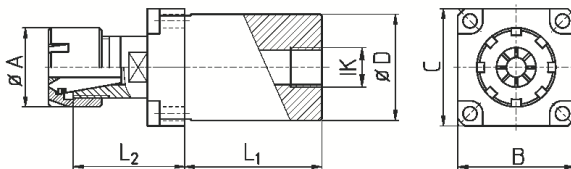
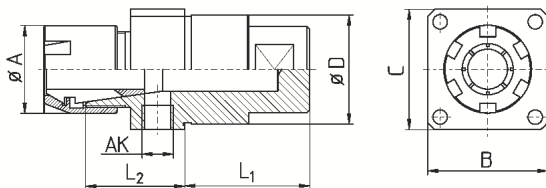
ER20M = M24 x 1

ER25M = M30 x 1

Artikel-Nr. article-no.	Original-Nr. original-no.	Zange collet	D	L <sub>1</sub>	L <sub>2</sub>	A	B	C	AK IK	Bild picture	Mutter nut	Maschinen-Typ machine type
* EM1130MM		ER11	30	45	29	16	32	39,5	G1/8"	1	ER11M	MAIER
* EM1630MM		ER16	30	45	26	22	31,5	39,5	G1/8"	1	ER16M	
EM1634MK		ER16	34	19,5	26	22	37,5	37,5	G1/4"	1	ER16M	MAIER
EM1634MM		ER16	34	44	26	22	37,5	37,5	M14x1,5	1	ER16M	
* EM1634MS		ER16	34	19	22	22	37,5	37,5	M11x1	1	ER16M	
EM2034MK		ER20	34	19,5	25	28	37,5	37,5	G1/4"	1	ER20M	STAR ECAS32T ST38 SV38R SX38
EM2034MK-AK1		ER20	34	19,5	34	28	37,5	37,5	G1/8"	2#	ER20M	
EM2034MM		ER20	34	44	25	28	37,5	37,5	G1/4"	1	ER20M	
* EM2534MK		ER25	34	19,5	5	35	37,5	37,5	G1/4"	1	ER25M	
* EM2534MK-AK1		ER25	34	19,5	42	35	37,5	37,5	G1/8"	2#	ER25M	
* EM2534MM		ER25	34	44	28	35	37,5	37,5	G1/4"	1	ER25M	
EM2034SV38R-AK1	101-01	ER20	34	39	31	28	37,5	37,5	G1/8"	2	ERC20M	
* EM2034SV38R-AK2		ER20	34	39	31	28	37,5	37,5	M8x1	2	ERC20M	

\* Ausverkaufsartikel  
# Schaft durchgehend zylindrisch

\* sellout article  
# shank throughout cylindrical



## ER-Zangenspannfutter für HANWHA / TORNOS

## ER-Collet Holders for HANWHA / TORNOS

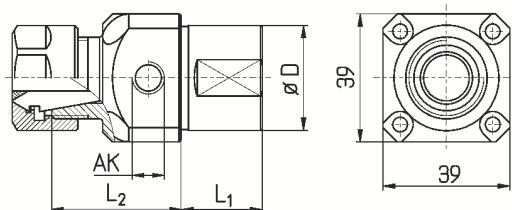

Artikel-Nr. article-no.	Zange collet	D	L <sub>1</sub>	L <sub>2</sub>	Mutter nut	Maschinen-Typ machine type
EU1632HA32-AK2	ER16	32	25	23,5	ERC16	HANWHA XD20 / 32H / 32I
EU1633HA20-AK1	ER16	33	37	35	ERC16	
EM2033HA20-AK1	ER20	33	37	35	ERC20M	
EU1632HA32-AK1	ER16	32	25	42	ERC16	HANWHA STL38
EU2032HA32-AK1	ER20	32	25	42	ERC20	
EU2032HA32-AK2	ER20	32	25	42	ERC20	
EM2532HA32-AK1	ER25	32	25	23,5	ERC25M	
EM2532HA32-AK2	ER25	32	25	23,5	ERC25M	
EM1628CT20-AK1	ER16	28	36	36	ERC16	TORNOS CT20
EU1628CT20-AK1	ER16	28	36	36	ERC16	
EM2028CT20-AK1	ER20	28	36	36	ERC20M	

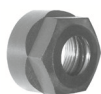

ERC16 = M22 x 1,5



ERC20M = M24 x 1



ERC20 = M25 x 1,5



ERC25M = M30 x 1

## ER-Zangenspannfutter für Doppelspindel-Maschinen

## ER-Collet Holders for Double Spindle Machines

Bild 1



Bild 2



UM/ER25 = M32 x 1,5

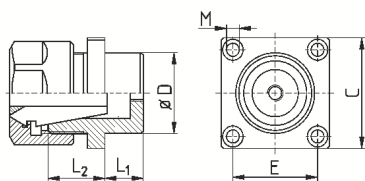
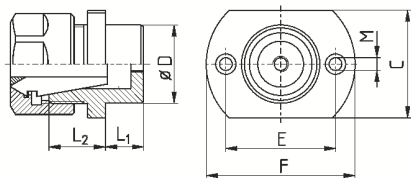

UM/ER32 = M40 x 1,5



UM/ER40 = M50 x 1,5

Artikel-Nr. article-no.	Zange collet	D	L <sub>1</sub>	L <sub>2</sub>	E	F	C	M	Bild picture	Mutter nut
* EU253220-HE	ER25	32	20	18	32	55	41	4,5	1	UM/ER25
* EU254020-HE	ER25	40	19,5	22	43	76	55	6,6	2	UM/ER25
* EU323220-HE	ER32	32	20	23,5	50	60	41	4,5	2	UM/ER32
* EU324020-HE	ER32	40	19,5	27	43	76	55	6,6	1	UM/ER32
* EU404020-HE	ER40	40	19,5	30	43	76	55	6,6	1	UM/ER40

\* Ausverkaufsartikel

\* sellout article

**ER-Zangenspannfutter**  
für STAR-Maschinen / Rückseitenbearbeitung

**ER-Collet Holders**  
for STAR-Machines / Backworking

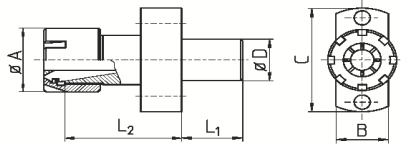

**Bild 1**

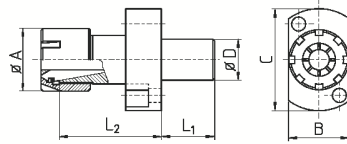

**Bild 2**

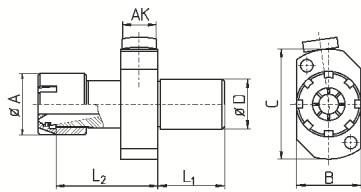

**Bild 3**

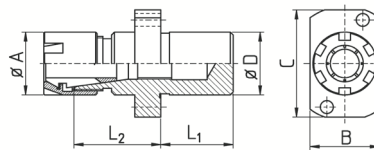

**Bild 4**

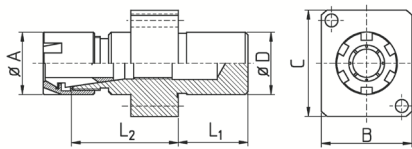

**Bild 5**

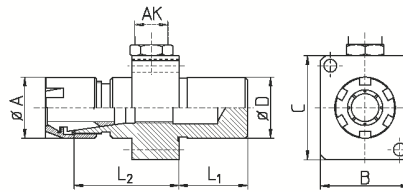

**Bild 6**

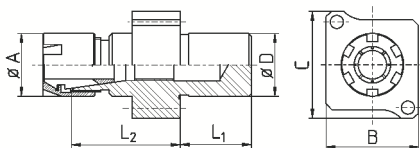

**Bild 7**

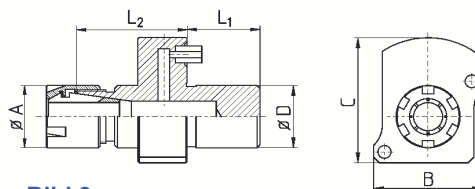

**Bild 8**

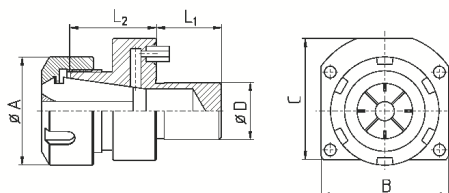

**Bild 9**

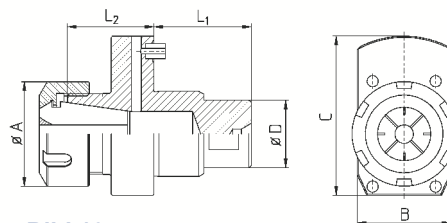

**Bild 10**

Artikel-Nr. article-no.	Original-Nr. original-no.	Zange collet	D	L <sub>1</sub>	L <sub>2</sub>	A	B	C	AK	Bild picture	Mutter nut	Maschinen-Typ machine type
EM1116SRJ	691-25	ER11	16	10	45	16	17	41	--	1	ER11M	SR10J (Pos T21 + T23)
EM1116SRJK		ER11	16	10	18	16	17	41	--	1	ER11M	
EM1116SR		ER11	16	20	17	16	24	40	--	4	ER11M	SR16; SR20
EU1116SR		ER11	16	20	17	20	24	40	--	4	UM/ER11	
EM1616SRMS		ER16	16	20	17	22	24	40	--	4	ER16M	
EM1616SROS *		ER16	16	20	17	22	24	40	--	4	ER16M	
EM1116SRR		ER11	16	10	18	16	17	41	--	1	ER11M	SR16R
EM1122SRR	691-24	ER11	22	25	46	16	28	49	--	2	ER11M	SR10J (Pos T22 + T24); SB12/20R; SB16/20; SR20J/JN; SR32J/JN; SR20 R/II/III; SV20R; SW12RII; ECAS12/20 SR20RIV (Pos T21-T24 verbaut/overlaps T25 - T28)
EM1622SRR	541-21-00	ER16	22	25	30	22	28	49	--	2	ER16M	
EM1622SRR-L		ER16	22	25	45	22	28	49	--	2	ER16M	
EM1622SRR-AK1		ER16	22	25	29	22	28	49	G1/8"	3	ERC16M	
EM1622SRR-AK2		ER16	22	25	29	22	28	49	M8x1	3	ERC16M	
EM1622SRR-c		ER16	22	25	21	22	28	49	--	2	ER16M	
EM2022SRR	671-22-00	ER20	22	25	27	28	28	49	--	2	ER20M	
EM2022SRR-AK1		ER20	22	25	30	28	28	49	G1/8"	3	ERC20M	
EM2022SRR-AK2		ER20	22	25	30	28	28	49	M8x1	3	ERC20M	
EM1622SW	OR1-22	ER16	22	25	38	22	32,5	37,5	--	5	ER16M	SW20; SW12RII; SV20R; SR20RIV; SB12/20R; SR38
EM1622SW-OS *		ER16	22	25	40	22	32,5	37,5	--	5*	ER16M	
EM1622SW-AK1	OR1-23 671-27	ER16	22	25	40	22	32,5	37,5	G1/8"	6	ERC16M	
EM1622SW-AK2		ER16	22	25	38	22	32,5	37,5	M8x1	6	ERC16M	
EM1622SW2-OS *	101-04	ER16	22	25	40	22	32,5	37,5	--	7*	ER16M	
EM2022SW	OT1-22	ER20	22	25	32	28	32,5	37,5	--	5	ER20M	
EM2022SW-AK1		ER20	22	25	32	28	32,5	37,5	G1/8"	6	ERC20M	
EM2022SW2-OS *	101-05	ER20	22	25	27	28	32,5	37,5	--	7*	ER20M	
EM2022SW-AK1		ER20	22	25	32	28	32,5	37,5	G1/8"	6	ERC20M	
EM1622SWS	OR1-21	ER16	22	25	31	22	24	37,5	--	4	ER16M	SW20 (Pos T24 + T28)
EM2022SR		ER20	22	25	28	28	38	48	--	2	ER20M	SR32; SR32J
EM1622SWIK	101-18	ER16	22	25	35	22	37,5	44	--	8	ERC16M	SR38; SR32JII; SX38
EM2022SWIK	101-19	ER20	22	25	33	28	37,5	44	--	8	ERC20M	
EU2522SWIK	101-21	ER25	22	25	33	42	49	47	--	9	ERC25	SR38
EU2534SX38-IK		ER25	34	39	34,5	42	37,5	63,5	--	10	ERC25	SX38

\* Ohne Innengewinde für Stellschraube

\* Without thread for backstop screw



ER11M = M13 x 0,75



ER16M = M19 x 1



ERC16M = M19 x 1



ER20M = M24 x 1



ERC20M = M24 x 1



ERC25 = M32 x 1,5

## ER-Zangenspannfutter mit B-Kegelaufnahme für Bohrmaschinen

## ER-Collet Holders with B-Cone

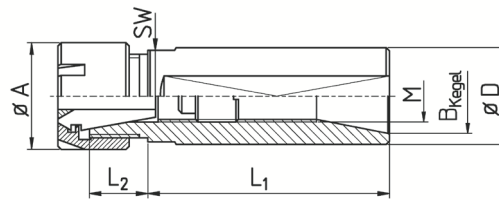

Artikel-Nr. article-no.	Typ / B-Kegel type / B-cone	Zange collet	D	L <sub>1</sub>	L <sub>2</sub>	A	M	Mutter nut	Schlüssel spanner
* EM11SB10	ER11M / B10	ER 11	16	40	12	16	M8	ER11M	E11M
* EM11LB10	ER11M / B10	ER 11	16	54	12	16	M8	ER11M	E11M
EM11SB12	ER11M / B12	ER 11	16	40	12	16	M8	ER11M	E11M
* EM11LB12	ER11M / B12	ER 11	16	60	12	16	M8	ER11M	E11M
* EM16SB10	ER16M / B10	ER 16	22	33	16	22	-	ER16M	E16M
* EM16LB10	ER16M / B10	ER 16	22	45	16	22	M10	ER16M	E16M
* EM16SB12	ER16M / B12	ER 16	22	33	16	22	-	ER16M	E16M
* EM16LB12S	ER16M / B12	ER 16	20	43	16	22	M10	ER16M	E16M
EM16LB12	ER16M / B12	ER 16	22	45	16	22	M10	ER16M	E16M
* EM16SB16	ER16M / B16	ER 16	22	33	15	22	-	ER16M	E16M
* EU16LB12	ER16 / B12	ER 16	22	54	14	28	M10	UM/ER16	GS25
* EM16LB16	ER16M / B16	ER 16	22	54	14	22	M10	ER16M	E16M
* EU16SB16	ER16 / B16	ER 16	22	35	12	28	-	UM/ER16	GS25
* EU16LB16	ER16 / B16	ER 16	22	53	15	28	M10	UM/ER16	GS25
* EM20B12	ER20M / B12	ER 20	25	50	16	28	M14	ER20M	E20M
EM20B16	ER20M / B16	ER 20	25	50	16	28	M14	ER20M	E20M
* EU20B16WD	ER20 / B16	ER 20	25	50	16	34	M14	UM/ER20	GS30
* EM20B18	ER20M / B18	ER 20	25	50	16	28	M14	ER20M	E20M
* EU25B16	ER25 / B16	ER 25	32	46	14	42	-	UM/ER25	E25
* EU32B22	ER32 / B22	ER 32	40	55	16	50	M20	UM/ER32	E32

\* Ausverkaufsartikel

\* sellout article



ER11M = M13 x 0,75



ER16M = M19 x 1

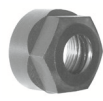

UM/ER16 = M22 x 1,5



ER20M = M24 x 1



UM/ER25 = M32 x 1,5



UM/ER32 = M40 x 1,5

## ER-Zangenspannfutter mit Anschlagbund; für Revolvermaschinen und INDEX MS25

## ER-Collet Holders with Stop Flange; for Revolving Machines and INDEX MS25

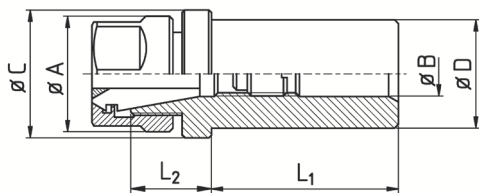

Artikel-Nr. article-no.	Zange collet	D	L1	L2	A	C	B	Mutter nut	Schlüssel spanner
* EB110820	ER11	8	20	18,5	16	16	-	ER11M	E11M
EB111015	ER11	10	15	15	16	20	-	ER11M	E11M
* EB111220	ER11	12	20	19	16	16	-	ER11M	E11M
EB111621WD	ER11	16	21	22	16	22	7	ER11M	E11M
* EB160820	ER16	8	20	24	28	19	-	UM/ER16	GS25
* EB161220	ER16	12	20	24	28	19	-	UM/ER16	GS25
EB162546	ER16	25	46	22	28	28	11	UM/ER16	GS25
* EB162546FL	ER16	25	46	22	28	30	11	UM/ER16	GS25
* EB162646	ER16	1"	46	21	28	28	11	UM/ER16	GS25
* EB203250WD	ER20	32	50	34	34	34	15	UM/ER20	GS30
EB252546	ER25	25	46	21	42	42	18	UM/ER25	E25
* EB252546FL	ER25	25	46	21	42	40	18	UM/ER25	E25
* EB252565-HE	ER25	25	65	23	42	32	8	UM/ER25	E25
EB252646K	ER25	1"	46	21	42	42	18	UM/ER25	E25
EB253238-HE	ER25	32	38	18	42	38	8	UM/ER25	E25
* EB253265-HE	ER25	32	65	23	42	39	8	UM/ER25	E25
* EB255082WD	ER25	50	82	23	42	59	7	UM/ER25	E25
* EB322565WD-HE	ER32	25	65	41	50	40	7	UM/ER32	E32
* EB324038-HE	ER32	40	38	23	50	49	8	UM/ER32	E32
* EB325082WD	ER32	50	82	29	50	59	7	UM/ER32	E32
EB404065-HE	ER40	40	65	30	63	50	10	UM/ER40	E40

\* Ausverkaufsartikel

\* sellout article



ER11M = M13 x 0,75

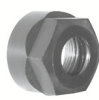

UM/ER16 = M22 x 1,5

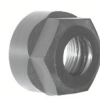

UM/ER20 = M25 x 1,5



UM/ER25 = M32 x 1,5



UM/ER32 = M40 x 1,5



UM/ER40 = M50 x 1,5

## VDI-Werkzeughalter ER, Form E4

## VDI Tool Holders ER, Form E4

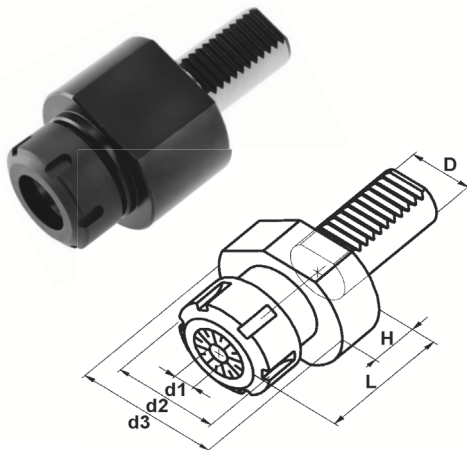

Artikel-Nr. article-no.	D	Zange collet	d1 min	d1 max	d2	d3	H	L
* EU16V16	16	ER16	1	10	28	40	13	41
* EU20V16	16	ER20	1	13	34	40	13	40
* EU16V20	20	ER16	1	10	28	50	20	43
* EU20V20	20	ER20	1	13	34	50	23	47
* EU25V20	20	ER25	1	16	42	50	25	50
* EU32V20	20	ER32	2	20	50	50	30	57
EU25V25	25	ER25	1	16	42	58	20	52
* EU32V25	25	ER32	2	20	50	58	20	58
EU25V30	30	ER25	1	16	42	68	25	50
EU32V30	30	ER32	2	20	50	68	30	57
* EU40V30	30	ER40	3	30	63	68	32	63
* EU25V40	40	ER25	1	16	42	83	25	52
* EU32V40	40	ER32	2	20	50	83	29	58
* EU40V40	40	ER40	3	30	63	83	32	63

\* Ausverkaufsartikel

\* sellout article

## ER-Zangenspannfutter MK mit Morsekonus DIN 2207

## ER-Collet Holders MT with Morse Taper DIN 2207

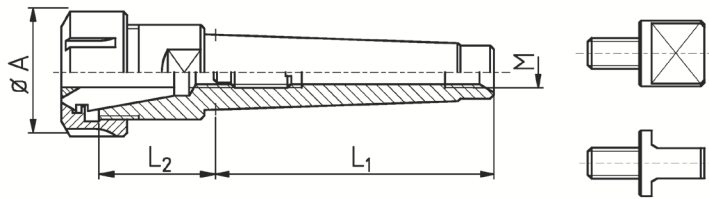

Artikel-Nr. article-no.	Typ / MK type / MT	Zange collet	M	L <sub>1</sub>	L <sub>2</sub>	A	Mutter nut	Schlüssel spanner
* EM16MK1	ER16 / MK1	ER16	M6	57	31	22	ER16M	E16M
EU11MK1	ER11 / MK1	ER11	M6	57	12	19	UM/ER11	GS17
* EU16MK1	ER16 / MK1	ER16	M6	57	31	28	UM/ER16	GS25
EU16MK2	ER16 / MK2	ER16	M10	67	32	28	UM/ER16	GS25
EU16MK3	ER16 / MK3	ER16	M12	86	30	28	UM/ER16	GS25
EU20MK2	ER20 / MK2	ER20	M10	68	32	34	UM/ER20	GS30
EU25MK2	ER25 / MK2	ER25	M10	68	35	42	UM/ER25	E25
* EU25MK2L	ER25 / MK2	ER25	--	80	52	42	UM/ER25	E25
EU25MK3	ER25 / MK3	ER25	M12	86	38	42	UM/ER25	E25
EU25MK4	ER25 / MK4	ER25	M16	109	37	42	UM/ER25	E25
EU32MK2	ER32 / MK2	ER32	M10	69	32	50	UM/ER32	E32
EU32MK3	ER32 / MK3	ER32	M12	86	52	50	UM/ER32	E32
* EU32MK3K	ER32 / MK3	ER32	M12	86	40	50	UM/ER32	E32
* EU32MK3L	ER32 / MK3	ER32	--	99	55	50	UM/ER32	E32
EU32MK4	ER32 / MK4	ER32	M16	108	48	50	UM/ER32	E32
EU40MK3	ER40 / MK3	ER40	M12	86	55	63	UM/ER40	E40
EU40MK4	ER40 / MK4	ER40	M15	109	55	63	UM/ER40	E40
EU40MK5	ER40 / MK5	ER40	M19	135	60	63	UM/ER40	E40
* EU50MK4	ER50 / MK4	ER50	M15	109	68	78	UM/ER50	E50
EU50MK5	ER50 / MK5	ER50	M19	136	70	78	UM/ER50	E50

MK-Futter auch mit Zangenaufnahme DIN 6388  
(OZ16, OZ25, OZ32) lieferbar

\* Ausverkaufsartikel

Morse taper holders also available with  
collet taper DIN 6388 (OZ)  
\* sellout article

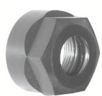

UM/ER11 = M14 x 0,75



ER16M = M19 x 1



UM/ER16 = M22 x 1,5

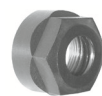

UM/ER20 = M25 x 1,5



UM/ER25 = M32 x 1,5  
UM/ER32 = M40 x 1,5



UM/ER40 = M50 x 1,5  
UM/ER50 = M64 x 2,0

## Austreiberlappen für MK-Futter

## Ejector Drift for MT-Holders

Artikel-Nr. - article-no.	TAG1	TAG2	TAG3	TAG4	TAG5
Gewinde - thread	M6	M10	M12	M16	M20

## ER-Zangenspannfutter SK mit Steilkegelschaft für GILDEMEISTER

**ER-Collet Holders**  
**BT Type for GILDEMEISTER**

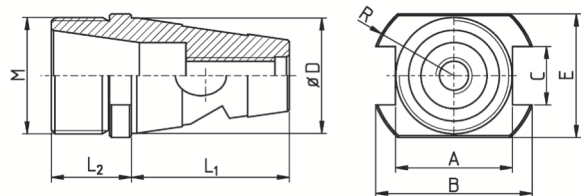

Artikel-Nr. article-no.	Typ / SK type / bt	Zange collet	M	L <sub>1</sub>	L <sub>2</sub>	A	B	C	E	R	Mutter nut	Schlüssel spanner
EU20ISO25	ER20 / ISO25	ER20	M25x1,5	42	19,7	25,9	32	12	32	14	UX/ER20	E20
EU20ISO30G	ER20 / ISO30	ER20	M25x1,5	43,5	22,6	32,2	43	16,1	34	21,2	UX/ER20	E20
* EU20ISO30K	ER20 / ISO30	ER20	M25x1,5	43,5	22,8	34	--	--	32,6	17,4	UX/ER20	E20
* EM25ISO30G	ER25M / ISO30	ER25	M30x1	43,5	22,6	32	43	16,1	34	21,2	ER25M	E25M
* EM25ISO30K	ER25M / ISO30	ER25	M30x1	43,5	22,5	34	--	--	32,5	18,5	ER25M	E25M
EU25ISO30G	ER25 / ISO30	ER25	M32x1,5	43,5	22,5	32,2	43	16,1	34	22,5	UM/ER25	E25
* EU25ISO30K	ER25 / ISO30	ER25	M32x1,5	43,5	22	34	--	--	32,7	18	UM/ER25	E25
EU32ISO30	ER32 / ISO30	ER32	M40x1,5	43,5	31	32,2	43	16,1	37,8	22	UM/ER32	E32
* EU32ISO40	ER32 / ISO40	ER32	M40x1,5	67,5	26	25*	*	20	50	32,25	UM/ER32	E32
EU40ISO40	ER40 / ISO40	ER40	M50x1,5	67,5	25	25*	*	20	50	32,25	UM/ER40	E40

\* Nut einseitig

\* Ausverkaufsartikel

\* Groove onesided

\* sellout article



UX/ER20 = M25 x 1,5



ER25M = M30 x 1



UM/ER25 = M32 x 1,5



UM/ER32 = M40 x 1,5



UM/ER40 = M50 x 1,5



## ER-Zangenspannfutter 2 Achsen verstellbar

## ER-Collet Holders 2 Axis Adjustable

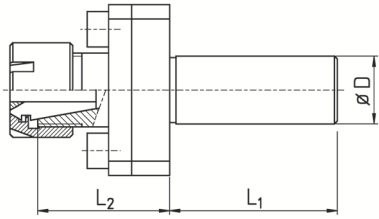

Artikel-Nr. article-no.	Zange collet	D	L <sub>1</sub>	L <sub>2</sub>	Mutter nut	Schlüssel spanner
V154.016	ER16	16	50	36	ER16M	E16M
V154.019	ER16	3/4"	50	36	ER16M	E16M
V154.020	ER16	20	50	36	ER16M	E16M
V154.022	ER16	22	70	36	ER16M	E16M
V154.025	ER16	25	70	36	ER16M	E16M
V154.026	ER16	1"	70	36	ER16M	E16M



ER16M = M19 x 1

## Bohrverlängerungen mit ER-Zangenspannfutter

## Drill Extensions with ER-Collet holders

Artikel-Nr. article-no.	Zange collet	M	D	L
* WT16ER11	ER11	M16x1	20	21
* WT16ER16	ER16	M16x1	20	24
* WT17ER11	ER11	M17x1	20	21
* WT22ER16	ER16	M22x1	27	22

\* Ausverkaufsartikel

\* sellout article

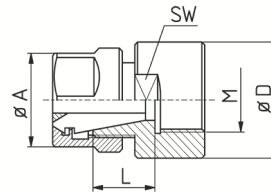

# Spannzangenreduktion

## *Collet Reduction*



## Spannzangenreduktionen mit Überwurfmutter UF

## Collet Reduction with Cap Nut UF

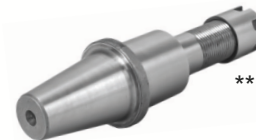
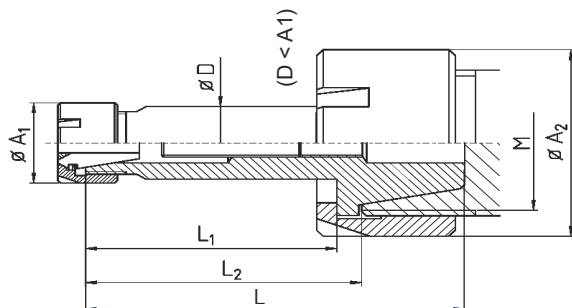

Artikel-Nr. article-no.	Kegel cone	Zange collet	UF-Mutter, Gewinde cap nut, thread	M	A <sub>1</sub>	A <sub>2</sub>	L <sub>1</sub>	L <sub>2</sub>	L	G
EQ11M/ER08	ER11	ER08	M13 x 0,75		12	19	8		28	M4
EQ11/ER08	ER11	ER08	M14 x 0,75		12	20	8		28	M4
EQ11M/ER16M	ER11	ER16 #	M13 x 0,75		22	19	27		47	-
EQ11/ER16M	ER11	ER16 #	M14 x 0,75		22	20	27		47	-
EQ11M/ER16	ER11	ER16 #	M13 x 0,75		22	19	27		47	-
EQ11/ER16	ER11	ER16 #	M14 x 0,75		22	20	38	41	56	-
EQ16M/F8L	ER16	F8	M19 x 1		20	SW22	50,5	53,5	70	M8
EQ16/F8L	ER16	F8	M22 x 1,5 *		20	28	50,5	53,5	70	M8
EQ16M/F8	ER16	F8	M19 x 1		20	SW22	31	34	53	M8
EQ16/F8	ER16	F8	M22 x 1,5 *		20	28	31	34	53	M8
EQ16M/ER08M	ER16	ER08	M19 x 1		12	SW22	27	30	48	M8
EQ16/ER08M	ER16	ER08	M22 x 1,5		12	28	27	30	48	M8
EQ16M/ER08M-HS207 **	ER16	ER08	M19 x 1		12	SW22	41	44	66	M8
EQ16/ER08M-HS207 **	ER16	ER08	M22 x 1,5		12	28	41	44	66	M8
EQ16M/ER11M	ER16	ER11	M19 x 1		16	SW22	16	19	38	M8
EQ16/ER11M	ER16	ER11	M22 x 1,5 *		16	28	16	19	38	M8
EQ16M/ER11ML	ER16	ER11	M19 x 1		16	SW22	32	35	57	M8
EQ16/ER11ML	ER16	ER11	M22 x 1,5 *		16	28	32	35	57	M8
EQ16M/ER11MXL	ER16	ER11	M19 x 1		16	SW22	53	56	78	M8
EQ16/ER11MXL	ER16	ER11	M22 x 1,5 *		16	28	53	56	78	M8
EQ20M/ER11M	ER20	ER11	M24 x 1		16	28	22	25	42	M8
EQ20/ER11M	ER20	ER11	M25 x 1,5		16	35	22	25	42	M8
EQ20M/ER16M	ER20	ER16	M24 x 1		22	28	22	25	48	M10
EQ20/ER16M	ER20	ER16	M25 x 1,5		22	35	25	28	48	M10
EQ25M/ER11M	ER25	ER11	M30 x 1		16	35	20	23	58	M12
EQ25/ER11M	ER25	ER11	M32 x 1,5		16	42	20	23	58	M10
EQ25M/ER11ML	ER25	ER11	M30 x 1		16	35	42	45	71	M12
EQ25/ER11ML	ER25	ER11	M32 x 1,5		16	42	42	45	71	M12
EQ25M/ER16M	ER25	ER16	M30 x 1		22	35	25	28	55	M12
EQ25/ER16M	ER25	ER16	M32 x 1,5		22	42	25	28	55	M12
EQ25M/ER16ML	ER25	ER16	M30 x 1		22	35	33	36	63	M12
EQ25/ER16ML	ER25	ER16	M32 x 1,5		22	42	33	36	63	M12
EQ25M/ER20	ER25	ER20	M30 x 1		34	35	16	19	50	M10
EQ25/ER20	ER25	ER20	M32 x 1,5		34	42	16	19	50	M10

Inkl. Überwurfmutter

\* Auch mit Mutter M22x1,25 (für TORNOS AS14/SAS16)

# Vergrößerung auf ER16

\*\* Zur Aufnahme von Zange und Säge

Supplied with cap nut

\* Also available with M22x1,25 (for TORNOS AS14/SAS16)

# Increases ER11 to ER16

\*\* For collet and milling cutter (Bild 2)

## ER Überwurfmuttern für Spannzangenreduktionen

## ER Cap Nuts for Collet Reduction

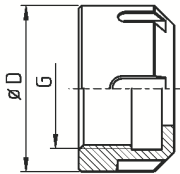

Artikel-Nr. article-no.	D	Gewinde thread G	Schlüssel spanner
UF/ER08M	16	M10x0,75	GS14
UF/ER11	19	M14x0,75	GS17
UF/ER11M	19,5	M13x0,75	GS17
UF/ER16	28	M22x1,5	GS25
UF/ER16M	SW22	M19x1	GS22
UF/ER20	35	M25x1,5	E25M
UF/ER20M	28	M24x1	E20M
UF/ER25	42	M32x1,5	E25
UF/ER25M	35	M30x1	E25M

## Spannzangenreduktionen für Standardmutter

## Collet Reduction for Standard Nut

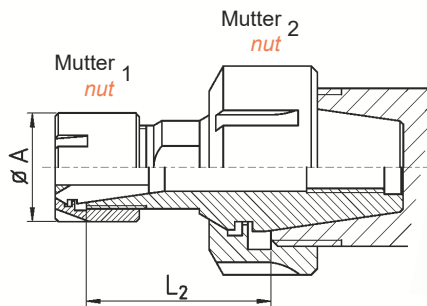
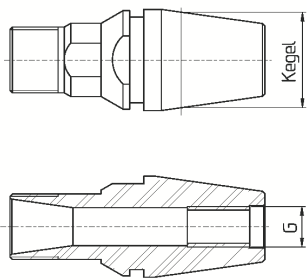

Artikel-Nr. article-no.	Kegel cone	Zange collet	Mutter nut 1	Mutter nut 2	A	L <sub>2</sub>	G	SW
* EQS20/ER11M	ER20	ER11	ER11M	ER20M / UM/ER20	16	24	M8x1	13
* EQS25/ER11M	ER25	ER11	ER11M	ER25M / UM/ER25	16	35	M8x1	14
* EQS32/ER11M	ER32	ER11	ER11M	UM/ER32	16	25	M10x1	14

Inkl. Mutter 1

\* Ausverkaufsartikel

Supplied with nut 1

\* sellout article

# ER - Doppelhalter

## *ER - Double Holders*



## ER-Doppelhalter für CNC-Maschinen mit Abgreifspindel

## ER-Double Holders for CNC-Lathes with Subspindle

Ausführungen:  
Versions:

FL: Spannfläche abgesetzt  
FL: Enclosed clamping flat

WD: Spannfläche durchgehend  
WD: Clamping flat throughout

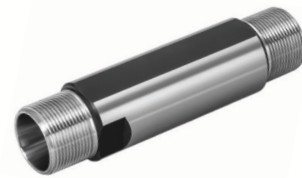
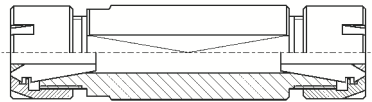
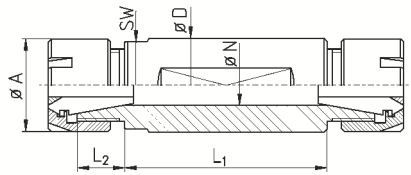

Artikel-Nr. article-no.	Original-Nr. original-no.	Zange collet	D	L <sub>1</sub>	L <sub>2</sub>	A	N	SW	Mutter nut	Schlüssel spanner
ED085818WD		ER08	5/8"	18	9	12	5,5	14	ER08M	E08M
ED085829WD		ER08	5/8"	29	9	12	5,5	14	ER08M	E08M
ED085835WD		ER08	5/8"	35	10	12	5,5	14	ER08M	E08M
ED085840WD		ER08	5/8"	40	10	12	5,5	14	ER08M	E08M
ED085845WD		ER08	5/8"	45	10	12	5,5	14	ER08M	E08M
ED115832WD		ER11	5/8"	32	12	16	7,5	14	ER11M	E11M
ED111632WD		ER11	16	32	12	16	7,5	14	ER11M	E11M
ED111650WD		ER11	16	50	12	16	7,5	14	ER11M	E11M
ED111672WD	691-22	ER11	16	72	12	16	7,5	14	ER11M	E11M
ED1116100WD		ER11	16	100	12	16	7,5	14	ER11M	E11M
ED111932WD		ER11	3/4"	32	12	16	7,5	17	ER11M	E11M
ED111940WD		ER11	3/4"	40	12	16	7,5	17	ER11M	E11M
ED111952WD		ER11	3/4"	52	12	16	7,5	17	ER11M	E11M
ED111965WD		ER11	3/4"	65	12	16	7,5	17	ER11M	E11M
ED111972WD		ER11	3/4"	72	12	16	7,5	17	ER11M	E11M
ED111995WD		ER11	3/4"	95	12	16	7,5	17	ER11M	E11M
ED112032WD		ER11	20	32	10	16	7,5	--	ER11M	E11M
ED112040WD		ER11	20	40	10	16	7,5	17	ER11M	E11M
ED112050WD		ER11	20	50	10	16	7,5	17	ER11M	E11M
ED112065WD		ER11	20	65	12	16	7,5	17	ER11M	E11M
ED112080WD		ER11	20	80	12	16	7,5	17	ER11M	E11M
EDU112080WD		ER11	20	80	12	16	7,5	17	UM/ER11	GS17
ED112232WD		ER11	22	32	12	16	7,5	19	ER11M	E11M
EDU112295WD		ER11	22	95	12	16	7,5	19	UM/ER11	GS17
EDU1122100WD	301-23-00	ER11	22	100	12	16	7,5	19	UM/ER11	GS17
ED161928FL		ER16	3/4"	28	14	22	11	17	ER16M	E16M
ED161934FL		ER16	3/4"	34	14	22	11	17	ER16M	E16M
ED161937FL		ER16	3/4"	37	12	22	11	17	ER16M	E16M
ED161958FL		ER16	3/4"	58	13	22	11	17	ER16M	E16M
ED161967FL		ER16	3/4"	67	14	22	11	17	ER16M	E16M
ED161975FL		ER16	3/4"	75	13	22	11	17	ER16M	E16M
ED161995FL		ER16	3/4"	95	15	22	11	17	ER16M	E16M
ED1619100FL		ER16	3/4"	102	14	22	11	17	ER16M	E16M
ED162032WD		ER16	20	32	15	22	11	17	ER16M	E16M
ED162050WD		ER16	20	50	15	22	11	17	ER16M	E16M
ED162055FL		ER16	20	55	15	22	11	17	ER16M	E16M
ED162062FL		ER16	20	62	15	22	11	17	ER16M	E16M
ED162075FL		ER16	20	75	15	22	11	17	ER16M	E16M
ED162240WD		ER16	22	40	15	22	11	19	ER16M	E16M
* ED162248WD		ER16	22	48	15	22	11	19	ER16M	E16M
ED162255WD		ER16	22	55	15	22	11	19	ER16M	E16M
ED162262WD		ER16	22	62	15	22	11	19	ER16M	E16M

\* Ausverkaufsartikel

\* sellout article

Artikel-Nr. article-no.	Original-Nr. original-no.	Zange collet	D	L <sub>1</sub>	L <sub>2</sub>	A	N	SW	Mutter nut	Schlüssel spanner
ED162267WD	421-22-00	ER16	22	67	14	22	11	19	ER16M	E16M
ED162275WD		ER16	22	75	15	22	11	19	ER16M	E16M
ED162284WD		ER16	22	84	16	22	11	19	ER16M	E16M
ED162290WD	421-27-00	ER16	22	90	16	22	11	19	ER16M	E16M
ED162295WD		ER16	22	95	16	22	11	19	ER16M	E16M
ED1622100WD		ER16	22	100	16	22	11	19	ER16M	E16M
ED1622120WD		ER16	22	120	15	22	11	19	ER16M	E16M
ED162360WD		ER16	23	60	16	22	11	19	ER16M	E16M
ED162562WD		ER16	25	62	16	22	11	22	ER16M	E16M
ED162621WD		ER16	1"	21	14	22	11	--	ER16M	E16M
ED162635WD		ER16	1"	35	14	22	11	--	ER16M	E16M
ED162635FL		ER16	1"	35	15	22	11	22	ER16M	E16M
ED162645FL		ER16	1"	45	15	22	11	22	ER16M	E16M
ED162645WD		ER16	1"	45	15	22	11	22	ER16M	E16M
ED162662WD		ER16	1"	62	16	22	11	22	ER16M	E16M
ED162668WD		ER16	1"	68	14	22	11	22	ER16M	E16M
ED162675FL		ER16	1"	75	15	22	11	22	ER16M	E16M
ED162680WD * / **		ER16	1"	80	17	22	11	22	ER16M	E16M
ED202548WD		ER20	25	48	16	28	14	22	ER20M	E20M
ED202575WD		ER20	25	75	16	28	14	22	ER20M	E20M
ED2025100WD		ER20	25	100	15	28	14	22	ER20M	E20M
ED202645WD		ER20	1"	45	16	28	14	--	ER20M	E20M
ED202675WD		ER20	1"	75	15	28	14	22	ER20M	E20M
ED203220WD		ER20	32	20	18	28	14	-	ER20M	E20M
ED203235WD	421-21-00	ER20	32	35	18	28	14	-	ER20M	E20M
ED203243WD		ER20	32	43	18	28	14	27	ER20M	E20M
ED203243FL		ER20	32	43	18	28	14	27	ER20M	E20M
ED203248WD		ER20	32	48	18	28	14	27	ER20M	E20M
ED203255WD	421-21-00	ER20	32	55	18	28	14	27	ER20M	E20M
ED203285WD	421-26-00	ER20	32	85	18	28	14	27	ER20M	E20M
EDU162680WD *		ER16	1"	80	17	22	11	22	UM/ER16	GS25
EDU253252FL		ER25	32	52	16	42	17	-	UM/ER25	E25

\* 1. Seite ER16 Standard / 2. Seite ER16 Mini

\*\* mit Langlochbohrung im Schaft

\* 1. thread ER16 standard / 2. thread ER16 mini

\*\* with oval bore in the shank

ER-Doppelhalter können gegen Aufpreis auf AK1-Anschluss (G1/8") umgearbeitet werden

ER-double holders can be changed to AK1-inner-coolant (G1/8") for extra charge



ER08M = M10 x 0,75



ER11M = M13 x 0,75



UM/ER11 = M14 x 0,75



ER16M = M19 x 1

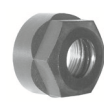

UM/ER16 = M22 x 1,5



ER20M = M24 x 1



UM/ER25 = M32 x 1,5



## ER-Doppelhalter mit unterschiedlichen Zangengrößen

## ER-Double Holders with Different Collet Sizes

### Ausführungen:

Versions:

FL: Spannfläche abgesetzt  
FL: Enclosed clamping flat

WD: Spannfläche durchgehend  
WD: Clamping flat through out

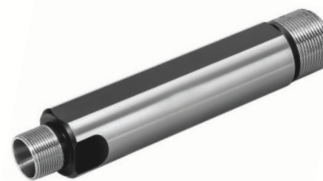
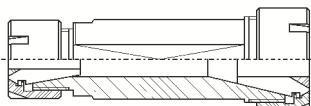
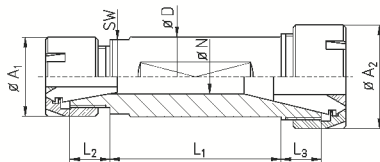

Artikel-Nr. article-no.	Original-Nr. original-no.	Zangen collets	D	L <sub>1</sub>	L <sub>2</sub>	L <sub>3</sub>	A <sub>1</sub>	A <sub>2</sub>	N	SW	Mutter nut	Schlüssel spanner
ED11/161680FL		ER11/16	16	80	12	21	16	22	7,5	17	ER11M / ER16M	E11M / E16M
ED11/161933FL		ER11/16	3/4"	33	12	14	16	22	7,5	17	ER11M / ER16M	E11M / E16M
ED11/161955FL		ER11/16	3/4"	55	12	13	16	22	7,5	17	ER11M / ER16M	E11M / E16M
ED11/161965WD		ER11/16	3/4"	65	12	14	16	22	7,5	17	ER11M / ER16M	E11M / E16M
EDU11/161983FL		ER11/16	3/4"	83	12	12	16	22	7,5	17	UM/ER11 / ER16M	GS17 / E16M
ED11/161996FL		ER11/16	3/4"	96	12	14	16	22	7,5	17	ER11M / ER16M	E11M / E16M
ED11/162032WD		ER11/16	20	32	12	15	16	22	7,5	17	ER11M / ER16M	E11M / E16M
ED11/162050FL		ER11/16	20	50	11	15	16	22	7,5	17	ER11M / ER16M	E11M / E16M
ED11/162050WD		ER11/16	20	50	11	15	16	22	7,5	17	ER11M / ER16M	E11M / E16M
ED11/162055WD		ER11/16	20	55	12	15	16	22	7,5	17	ER11M / ER16M	E11M / E16M
EDU11/162082WD		ER11/16	20	82	11	12	16	22	7,5	-	UM/ER11 / UM/ER16	GS17 / GS25
EDU11/162290WD		ER11/16	22	90	12	16	19	22	7,5	19	UM/ER11 / ER16M	GS17 / E16M
EDU11/162292FL	461-22	ER11/16	22	92	12	16	19	22	7,5	19	UM/ER11 / ER16M	GS17 / E16M
EDU11/162292AK1WD		ER11/16	22	92	12	16	19	22	7,5	G1/8"	UM/ER11 / ER16M	GS17 / E16M
ED16/202630WD		ER16/20	1"	30	16	16	22	28	11	-	ER16M / ER20M	E16M / E20M
ED20/252562FL		ER20/25	25	62	22	22	28	35	14	27	ER20M / ER25M	E20M / E25M
ED20/252575WD		ER20/25	25	75	18	29	28	35	14	27	ER20M / ER25M	E20M / E25M
ED20/252662FL		ER20/25	1"	62	24	34	28	35	14	27	ER20M / ER25M	E20M / E25M
ED20/253250WD		ER20/25	32	50	25	25	28	35	14	27	ER20M / ER25M	E20M / E25M
ED20/253255WD		ER20/25	32	55	25	25	28	35	14	27	ER20M / ER25M	E20M / E25M



ER11M = M13 x 0,75



UM/ER11 = M14 x 0,75



ER16M = M19 x 1



UM/ER16 = M22 x 1,5



ER20M = M24 x 1



ER25M = M30 x 1

## ER-Doppelhalter mit innerer Kühlmittelzufuhr

## ER-Double Holders with Inner Coolant

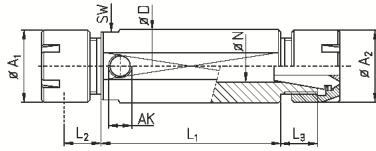

Artikel-Nr. article-no.	Zange collet	D	L <sub>1</sub>	L <sub>2</sub>	L <sub>3</sub>	A	N	AK	SW	Mutter nut	Schlüssel spanner
ED11/162295AK1WD	ER11/16	22	91	13	16	19/22	7,5	G1/8"	-	ER11M/ERC16M	E11M/E16M
ED162270AK1WD	ER16	22	70	16	16	22	11	G1/8"	19	ERC16M	E16M
ED162289AK1WD	ER16	22	89	16	16	22	11	G1/8"	-	ERC16M	E16M
ED1622100AK1WD	ER16	22	100	16	16	22	11	G1/8"	-	ERC16M	E16M
ED16/202270AK1WD	ER16/20	22	70	15	15	22/28	11	G1/8"	19	ERC16M/ERC20M	E16M/E20M
ED203255AK1WD	ER20	32	55	18	18	28	14	G1/8"	27	ERC20M	E20M
ED203255AK2WD	ER20	32	55	18	18	28	14	M8x1	27	ERC20M	E20M
ED203265AK1WD	ER20	32	64	18	18	28	14	G1/8"	-	ERC20M	E20M
ED203285AK1WD	ER20	32	85	18	18	28	14	G1/8"	27	ERC20M	E20M



ER11M = M13 x 0,75



ERC16M = M19 x 1



ERC20M = M24 x 1

für Dichtscheiben - for sealing disks

# Zangenspannfutter Divers

## *Collet Holders Divers*



## Zangenspannfutter DIN 6388 für OZ-Zangen

## Collet Holders DIN 6388 for OZ-Collets

Bild 1



Bild 2



Artikel-Nr. article-no.	Zange Form A collet type A	Zange Form B collet type B	D	L <sub>1</sub>	L <sub>2</sub>	A	SW	Bild picture	Mutter nut
* EOZ162550FL	410E	415E	25	50	49	43	30	1	OZ16
* EOZ16MK2	410E	415E	MK2 / MC2		45	43	24	2	OZ16
* EOZ16MK3	410E	415E	MK3 / MC3		41	43	24	2	OZ16
* EOZ16MK4	410E	415E	MK4 / MC4		32	43	30	2	OZ16
* EOZ16MK5	410E	415E	MK5 / MC5			43		2	OZ16
* EOZ253268FL-CNC	444E	462E	32	68	52	58	-	1	OZ25
* EOZ25MK2	444E	462E	MK2 / MC2		55	58	41	2	OZ25
EOZ25MK3	444E	462E	MK3 / MC3		59	58	32	2	OZ25
EOZ25MK4	444E	462E	MK4 / MC4		62	58	32	2	OZ25
* EOZ25MK5	444E	462E	MK5 / MC5		56	58	45	2	OZ25
* EOZ255080FL-S-CNC	444E	462E	50	80	25	58	-	1	OZ25
EOZ32MK4	450E	467E	MK4 / MC4		61	72	45	2	OZ32
EOZ32MK5	450E	467E	MK5 / MC5		62	72	45	2	OZ32
* EOZ3232100	450E	467E	32	100	67	72	46	1	OZ32
* EOZ40MK4	453E	468E	MK4 / MC4		88	85	45	2	OZ40
* EOZ40MK5	453E	468E	MK5 / MC5		88	85	45	2	OZ40

\* Ausverkaufsartikel

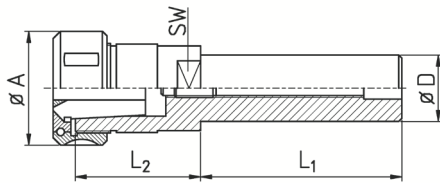
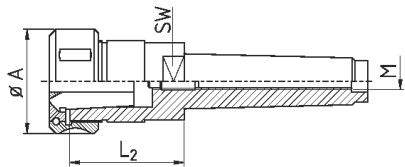
\* sellout article

## Austreiberlappen für MK-Futter

## Ejector Drift for MT-Holders

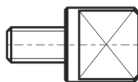

Siehe S. 95

-

see page 95

## Klemmkonusse

für Zangenaufnahmen Reihe 100 (Typ F)

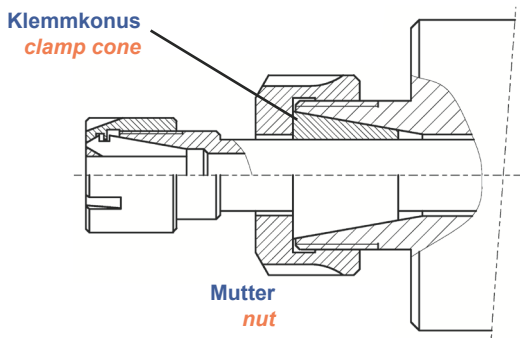

Artikel-Nr. article-no.	Typ type	ersetzt Zange Nr. replaces collet no.
* KKF8-16	8 - 16°	101E / F8
* KKF10-20	10 - 20°	109E / 111E / F10

\* Ausverkaufsartikel \* sellout article

## Clamp Cones

for collet holders type 100 (type F)

## Zangenspannfutter Reihe 600

## Collet Holders Type 600

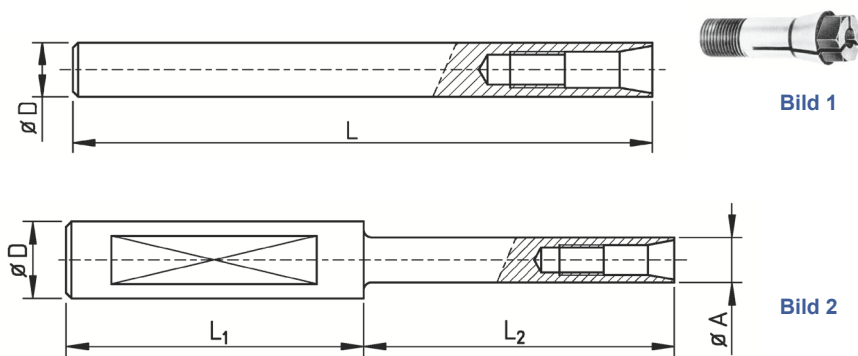

Aufnahmen gehärtet und geschliffen

HOLDERS are hardened and ground

Artikel-Nr. article-no.	Zange collet	D	L	L <sub>1</sub>	L <sub>2</sub>	A	Bild picture
E6023/06100	6023E	6	100	80	20	7,2	2
E6023/07100	6023E	7	100	-	-	-	1
E6023/0870	6023E	8	70	-	-	-	1
E6023/08100	6023E	8	100	-	-	-	1
E6023/08150	6023E	8	150	-	-	8	1
E6023/08200	6023E	8	200	-	-	8	1
* E6043/0930	6043E	9	30	-	-	-	1
* E6043/0940	6043E	9	40	-	-	-	1
E6043/09100	6043E	9	100	-	-	-	1
E6043/10100S	6043E	10	100	50	50	9	2
* E600/10100	600E	10	100	-	-	-	1
* E600/10125	600E	10	125	-	-	-	1
E601/12100	601E	12	100	-	-	-	1
E601/16100	601E	16	100	-	-	-	1
* E601/16160	601E	16	160	-	-	-	1
* E601/1890-2WD	601E	18	90	-	-	-	1

Aus Vergütungsstahl

Material: Heat-treated steel

Klemmfläche oder Durchgangsbohrungen mit Aufpreis

Clamping flat or through-bore for extra charge

\* Ausverkaufsartikel

\* sellout article

## Zangenspannfutter für JACOBS Rubber-Flex Zangen

*Collet Holders  
for JACOBS Rubber-Flex*

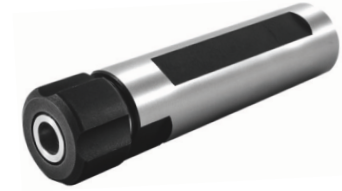
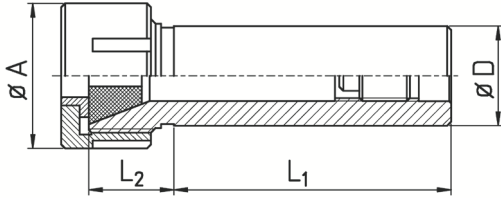

Artikel-Nr. article-no.	Orig. Nr. TRAUB / INDEX orig.-no. TRAUB / INDEX	Zange collet	D	L <sub>1</sub>	L <sub>2</sub>	A	Bereich range	Mutter nut
* ROZ 3161	Tb 315 003 W12.126.0046	41	3/4"	46	19	21	1 - 6,5	ROZ 3157
* ROZ 3162		41	16mm	46	19	21	1 - 6,5	ROZ 3157
* ROZ 3164FL		41	20	70	19	21	1 - 6,5	ROZ 3157
* ROZ 3170	Tb 315 005 W12.121.0046	42	3/4"	46	19	31	2 - 10	ROZ 3158
* ROZ 3171	Tb 614 666	42	1"	46	19	31	2 - 10	ROZ 3158
* ROZ 3172 *		42	25mm	46	19	31	2 - 10	ROZ 3158
* ROZ 3173 *		42	20mm	46	19	31	2 - 10	ROZ 3158
* ROZ 3180	Tb 614 665 W32.121.00	44	1"	46	33	40	1,8 - 13 (15)	ROZ 3159
* ROZ 3182 *		44	25mm	46	33	40	1,8 - 13 (15)	ROZ 3159
* ROZ 3184 *		44	20mm	46	33	40	1,8 - 13 (15)	ROZ 3159
* ROZ 3185		44	3/4"	46	33	40	1,8 - 13 (15)	ROZ 3159

\* Auch mit Klemmfläche lieferbar

\* Ausverkaufsartikel

\* Also available with clamping flat

\* sellout article

# INOGRIP ER - Hydrodehnaufnahme für ER Spannzangenhalter

## INOGRIP ER - Hydro Chuck for ER Collet Holders

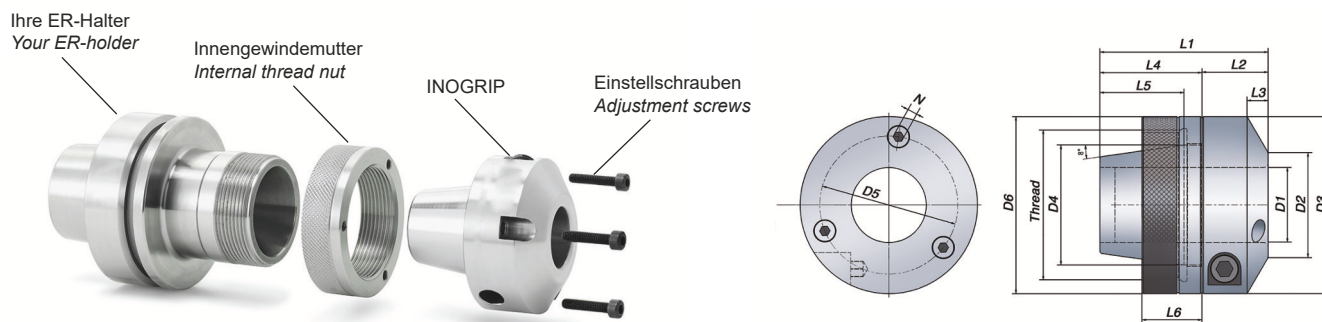

ER größe size	Artikel-Nr. article-no.	Abmessungen, mm Dimensions, mm										Einstellschrauben Adjustment screws				Innengewindemutter Internal thread nut			
		D1	D2	D3	D4	L1	L2	L3	L4	L5	D5	No.	Dim.	N	D6	L6	Gewinde Thread	T* Nm	
16	INOGRIP-ER16-6	6	16	34	16	30	14	5	16	14	28	2	M3x16*	2,5	34	10	M22x1,5	6-14	
	INOGRIP-ER16M-6	6	16	34	16	30	14	5	16	14	28	2	M3x16*	2,5	34	10	M19x1	6-14	
20	INOGRIP-ER20-12	12	22	43,5	20	40	24	7	16	14	34	3	M4x20	3	43,5	12	M25x1,5	50-90	
	INOGRIP-ER20M-12	12	22	43,5	20	40	24	7	16	14	34	3	M4x20	3	43,5	12	M24x1	50-90	
25	INOGRIP-ER25-12	12	26	48	25	46	26	7	20	18	41	3	M4x20	3	48	13	M32x1,5	50-90	
	INOGRIP-ER25M-12	12	26	48	25	46	26	7	20	18	41	3	M4x20	3	48	13	M30x1	50-90	
	INOGRIP-ER25-16	16	26	48	25	46	26	7	20	18	41	3	M4x20	3	48	13	M32x1,5	120-200	
	INOGRIP-ER25M-16	16	26	48	25	46	26	7	20	18	41	3	M4x20	3	48	13	M30x1	120-200	
32	INOGRIP-ER32-20	20	30	52	32	52	25,5	7	26,5	24,5	45	3	M4x20	3	52	15	M40x1,5	230-370	
40	INOGRIP-ER40-25	25	35	59	40	56	22	7	34	28	46	4	M4x16	3	59	20	M50x1,5	420-600	
50	INOGRIP-ER50-32**	32	42	69,5	50	60	22	7	38	32	56	5	M4x15	3	78	20	M64x2	660-1000	

Artikel besteht aus INOGRIP + Zwischenmutter + Einstellschrauben

Article consist of INOGRIP + connection nut + adjustment screws

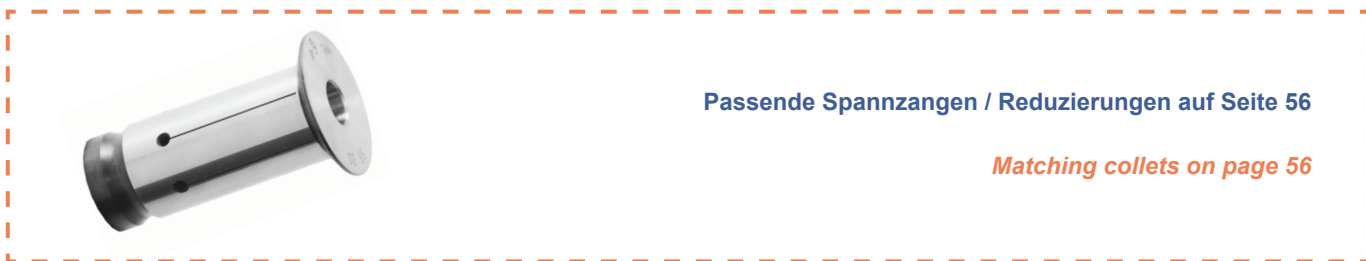

Passende Spannzangen / Reduzierungen auf Seite 56

Matching collets on page 56